

SMART™

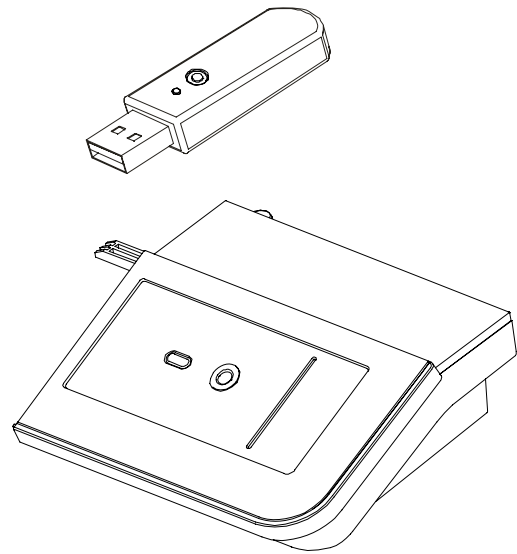

Service Parts Diagrams

**For Model:
WC8**

Service Parts Diagrams Revision History

Revision 1 - May, 2011

- New document

Standard Warranty Terms

Base product: One-year limited equipment warranty

First Customer Ship: March, 2011

SMART Technologies

3636 Research Road NW
Calgary, AB T2L 1Y1
CANADA

Support +1.403.228.5940 or Toll Free 1.866.518.6791 (Canada/U.S.)

Support Fax +1.403.806.1256

ServiceParts@smarttech.com www.smarttech.com



Service Parts Diagrams for the WC8

Identifying Your Product Using the Serial Number 1

Ordering Parts 1

WC8 Parts 2

Identifying Your Product Using the Serial Number

To make sure that you have the correct service parts diagrams, you must verify the serial number of your WC8. The serial number will be located on the bottom of the pen tray module. An example of the serial number format is shown below.

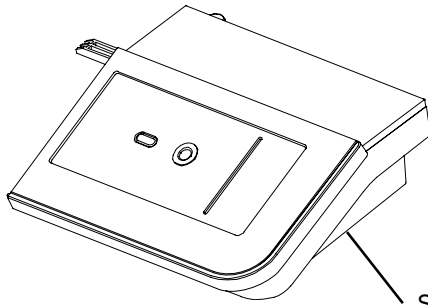

Serial Number Location

H012DW07B0001

Serial Number Example

Ordering Parts

Customers

To order any of the parts in these service parts diagrams, contact your local reseller. To find a reseller near you, visit www.smarttech.com/where.

Dealers and Distributors

For specific technical and pricing enquiries in regards to these diagrams please contact our service parts department. Pricing is also available on-line via the SOURCE website (source.smarttech.com).

E-mail: serviceparts@smarttech.com
Phone: 1.888.42.SMART
International: +1.403.245.0333

WC8 Parts

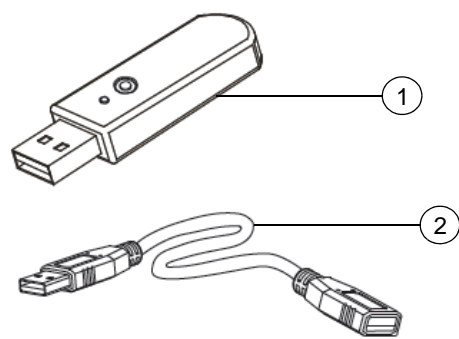

Item	Part No.	Qty	Description
1	20-01435-20	1	Dongle, PC, WC8
2	93-00819-20	1	Cable, USB, extender, A-A, 4' (1.2 m)