

In-Wall Rear Projection
SMARTBoard™

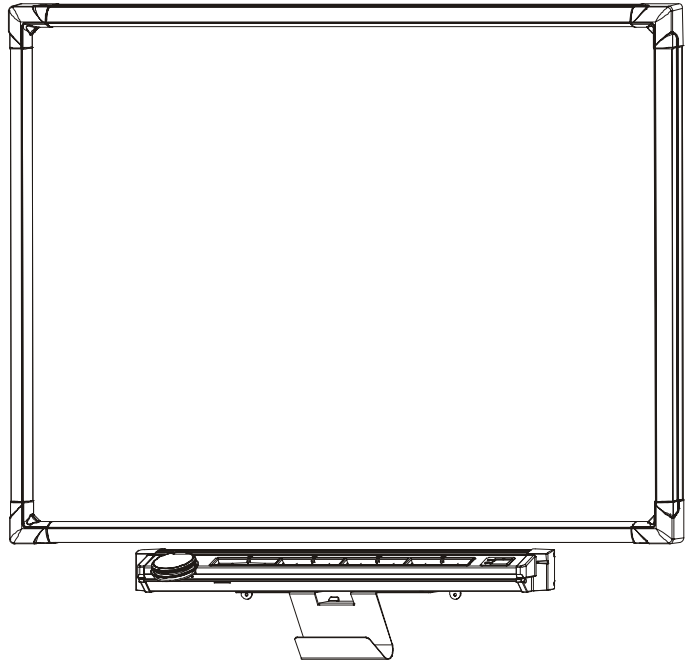

Service Parts Diagrams

For Model:
WRPSB 1810-DV

Service Parts Diagrams Revision History

Revision 1 - October, 2004

- New document

Revision 2 - December, 2006

- Added new RoHS part numbers

Revision 3 - June, 2007

- Change 93-00583-20 to 93-00583-21

Revision 4 - July, 2007

- Add reference to R2 serial number

Revision 5 - November, 2009

- Change 60-00035-20 to 60-00051-20

Standard Warranty Terms

Base Product: 2 years

Accessories: 1 year

First Customer Ship: June, 2003

SMART Technologies

3636 Research Road NW

Calgary, AB T2L 1Y1

CANADA

Support +1.403.228.5940 or Toll Free 1.866.518.6791 (Canada/U.S.)

Support Fax +1.403.806.1256

ServiceParts@smarttech.com www.smarttech.com



© 2009 SMART Technologies ULC. All rights reserved. SMART Board, smarttech and the SMART logo are trademarks or registered trademarks of SMART Technologies ULC in the U.S. and/or other countries. All other third-party product and company names are for identification purposes only and may be trademarks of their respective owners. Contents are subject to change without notice. 11/2009.

Service Parts Diagrams for the In-Wall *Rear Projection* SMART Board™ 1810-DV Interactive Whiteboard

| | |
|---|---|
| Identifying Your Product Using the Serial Number | 1 |
| Ordering Parts | 1 |
| Overview | 2 |
| Front View of Interactive Whiteboard (Part No. FRU-RB472-x) | 3 |
| Rear View of Interactive Whiteboard (Part No. FRU-RB472-x) | 4 |
| Pen Tray (Part No. PT12CW-xx) | 5 |
| Accessory Kit (Part No. AK-00073-21) | 6 |

Identifying Your Product Using the Serial Number

To make sure that you have the correct Service Parts Diagrams, you must verify the serial number of your SMART product. For the In-Wall *Rear Projection* SMART Board 1810-DV interactive whiteboard with DViT™ technology, the serial number is located on the bottom of the interactive whiteboard, towards the right side, viewed from the front.

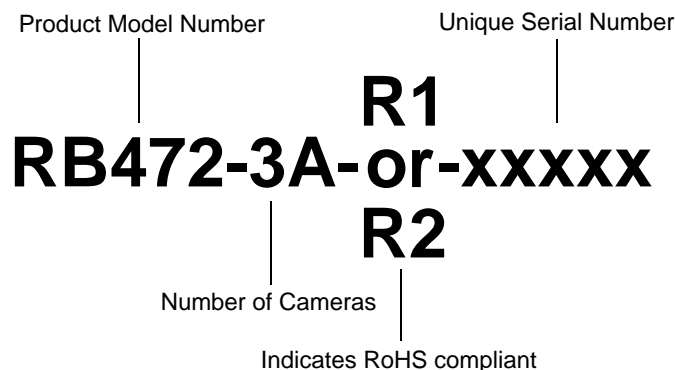
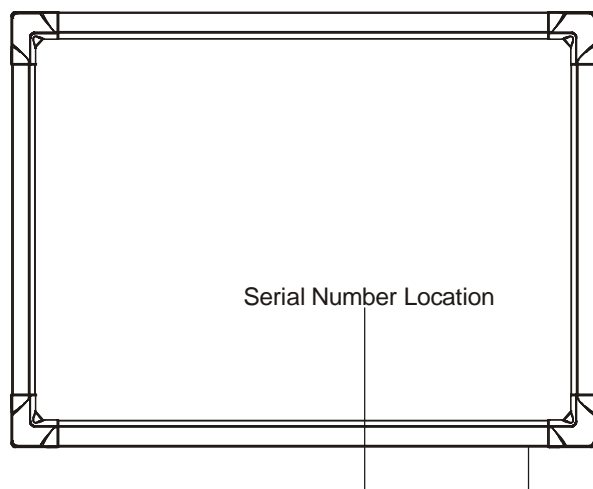

For non-RoHS compliant models, the serial number will match this format: RB472-3A-xxxxx.

For RoHS compliant (Europe) models, the serial number will match this format: RB472-3A-R1-xxxxx.

For RoHS compliant (Europe and China) models, the serial number will match this format: RB472-3A-R2-xxxxx.

Your In-Wall *Rear Projection* SMART Board interactive whiteboard may have either three or four cameras. You can determine how many cameras are in your system by the serial number. If the serial number contains "3A", then you have a three-camera system. If the serial number does not contain "3A", then you have a four-camera system (eg. RB472-xxxxx).

Ordering Parts

Customers

To order any of the parts in these service parts diagrams, contact your local reseller.
To find a reseller near you, visit www.smarttech.com/where.

Dealers and Distributors

For specific technical and pricing enquiries in regards to these diagrams please contact our service parts department. Pricing is also available on-line via the SOURCE website (source.smarttech.com).

E-mail: serviceparts@smarttech.com
Phone: 1.888.42.SMART
International: +1.403.245.0333

Overview

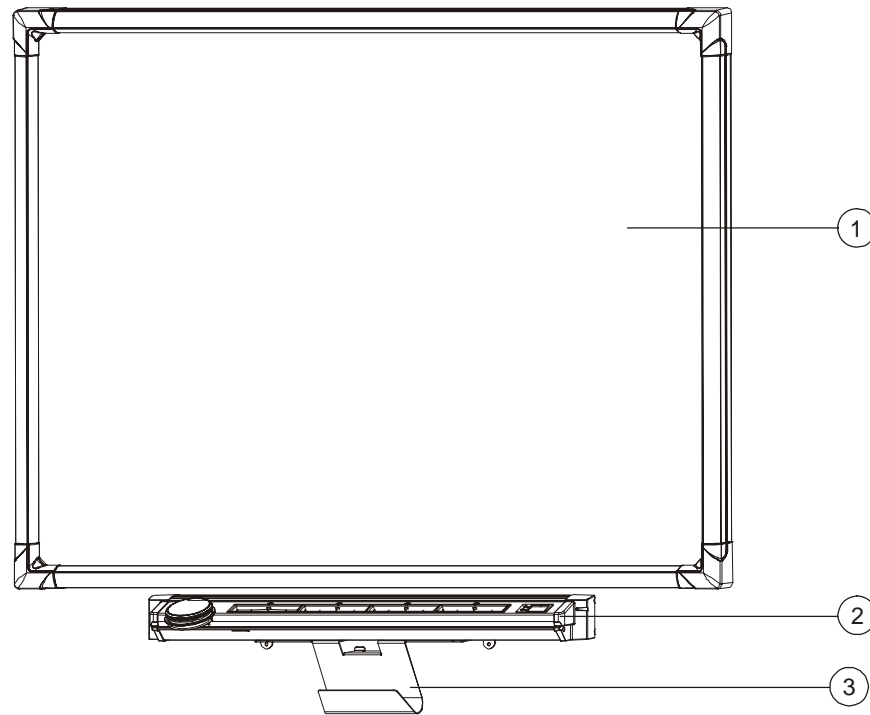

| Item | Part No. | Qty | Description |
|-----------|-------------|-----|---|
| 1 | FRU-RB472-x | 1 | FRU, RB472, replacement screen, 72" NOTE: Contact Technical Support for firmware version verification. |
| 2 | PT12CW-xx | 1 | Pen tray, assembly NOTE: Part no. PT12CW-01 for version 3.x firmware, part no. PT12CW-20 for version 4.x firmware. Please contact Technical Support for verification. |
| 3 | 51-00035-20 | 1 | Bracket, pen tray and keyboard holder NOTE: Included with PT12CW-01 and PT12CW-20 |
| Not shown | 57-00420-01 | 1 | Packaging, WRPSB 1810-DV NOTE: Order with 57-00433-02 and 57-051-01. |
| Not shown | 57-00433-02 | 1 | Cover, diffusion, WRPSB 1810-DV NOTE: Order with 57-00420-01 and 57-051-01. |
| Not shown | 57-051-01 | 1 | Bag, shipping, WRPSB 1810-DV NOTE: Order with 57-00420-01 and 57-00433-02. |
| Not shown | WM72-010-02 | 2 | Bracket, wall mount, interactive whiteboard |
| Not shown | 03-00095-20 | 1 | Keyboard, wireless NOTE: For product with a serial number format that contains "R1" or "R2" |
| Not shown | 03-00042 | 1 | Keyboard, wireless, includes IR sensor NOTE: For product with a serial number format that does not contain "R1" or "R2" |
| Not shown | AK-00073-21 | 1 | Kit, accessory, in-wall |

Front View of Interactive Whiteboard (Part No. FRU-RB472-x)

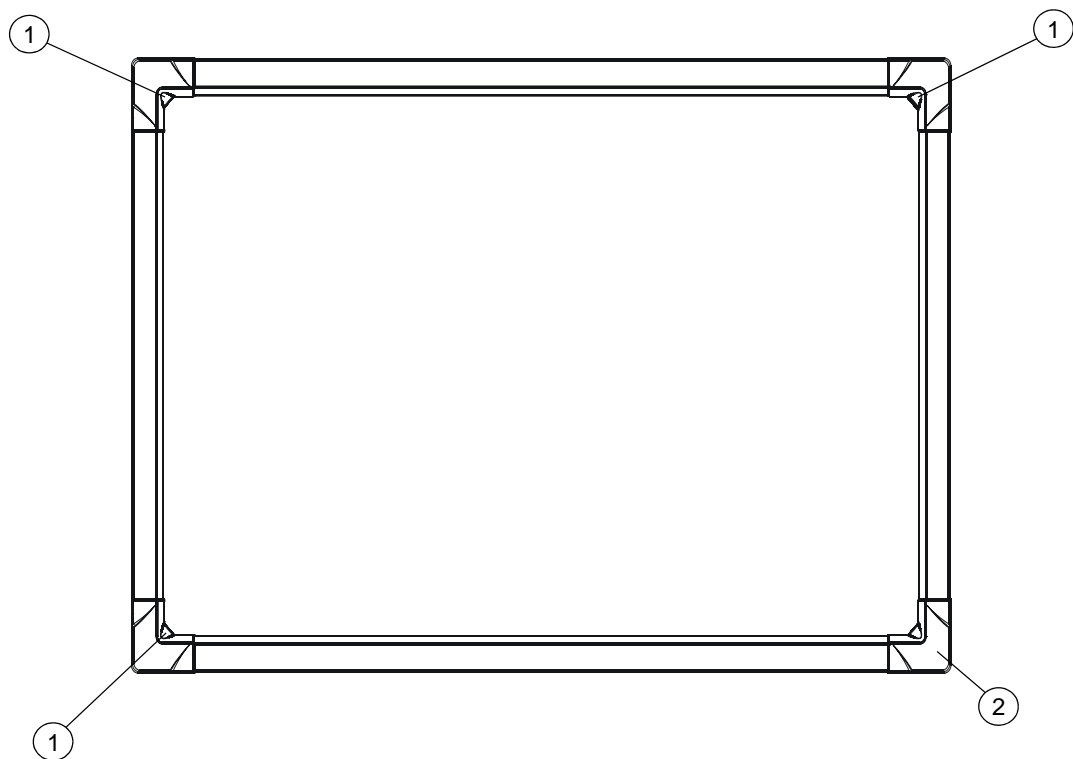

| Item | Part No. | Qty | Description |
|-----------|---------------|-----|--|
| 1 | FRU-DV-CAMx-y | 3 | FRU, camera, DViT NOTE: Call Technical Support for firmware version verification. |
| 2 | 52-00153-00 | 4 | Corner cap, outer, silver |
| Not shown | FRU-LED-72 | 1 | FRU, LED replacement strips, all four sides |
| Not shown | FRU-LED-72L | 2 | FRU, LED replacement strip, long |
| Not shown | FRU-LED-72S | 2 | FRU, LED replacement strip, short |
| Not shown | 93-00374-20 | 2 | Cable, MOD8 to MOD8, 6' 6" (2 m) NOTE: Connects the top left and top right cameras to the hub, viewed from the rear. |
| Not shown | 93-00384-20 | 1 | Cable, MOD8 to MOD8, 2' 11" (88 cm) NOTE: Connects the bottom right camera to the hub, viewed from the rear. |

Rear View of Interactive Whiteboard (Part No. FRU-RB472-x)

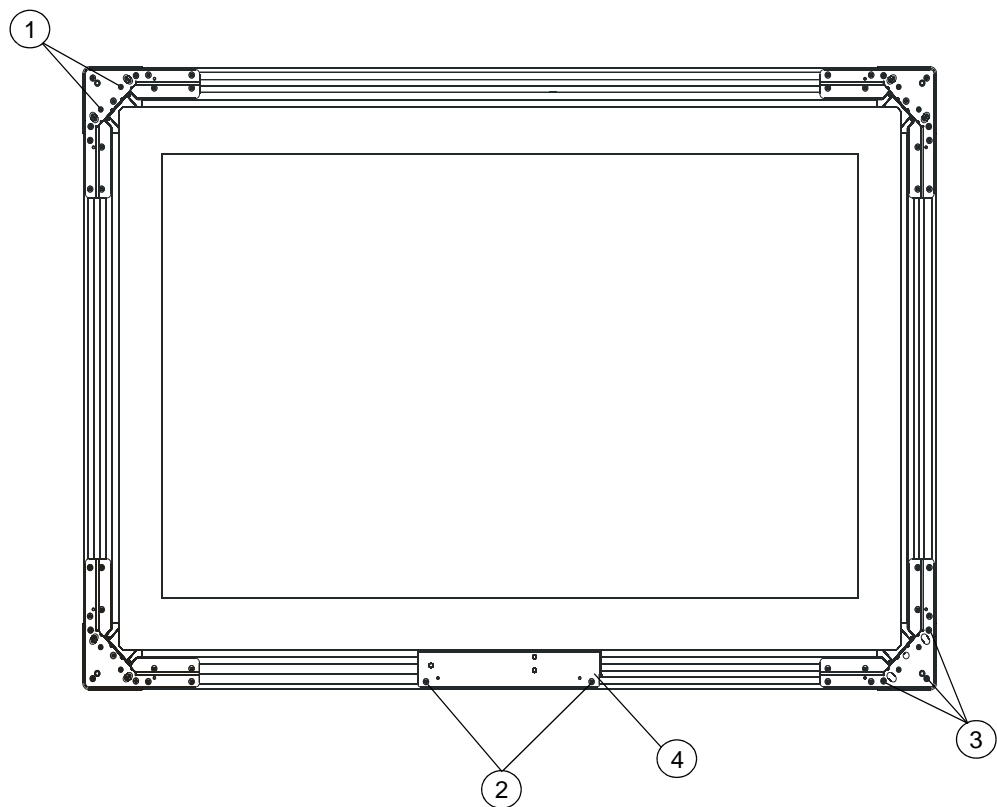

| Item | Part No. | Qty | Description |
|------|-------------|-----|--|
| 1 | 30-00885 | 8 | Screw, 8-32 x 3/8", Phillips, flat head, undercut NOTE: For attaching cameras. |
| 2 | 30-00653-20 | 2 | Screw, 10-32 x 3/8", square recess, flat head NOTE: For attaching hub. |
| 3 | 30-00719-20 | 12 | Screw, No. 10 x 3/4", Phillips, flat head, for plastics NOTE: For attaching corner caps. |
| 4 | FRU-DV-HUB1 | 1 | FRU, hub, assembly |

Pen Tray (Part No. PT12CW-xx)

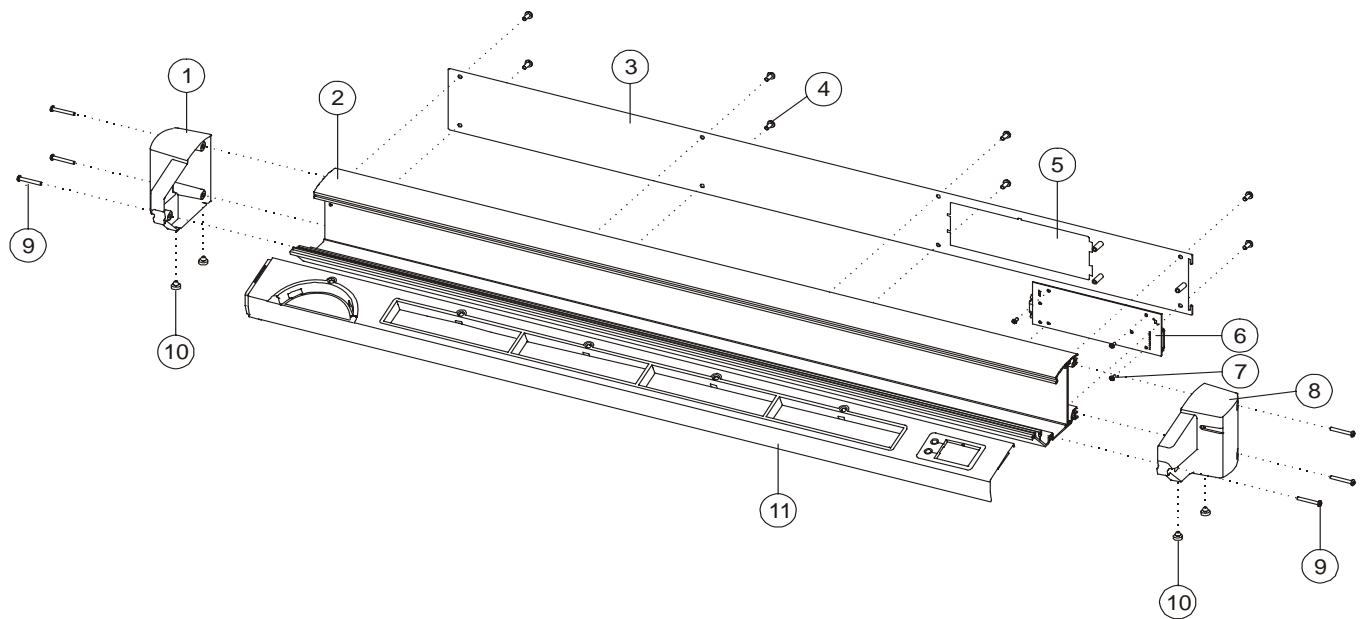

| Item | Part No. | Qty | Description |
|-----------|-----------------|-----|--|
| 1 | 52-00003-02 | 1 | End cap, pen tray, left, silver |
| 2 | 51-00262-00 | 1 | Extrusion, pen tray, silver |
| 3 | 51-00127-20 | 1 | Back plate, pen tray |
| 4 | 30-419 | 8 | Screw, 8-32 x 1/4", Phillips, pan head NOTE: For attaching pen tray back plate. |
| 5 | 52-0002-00 | 1 | Grommet, cable |
| 6 | FRU-DV-SC8-x | 1 | FRU, replacement serial controller NOTE: Call Technical Support for firmware version verification. |
| 7 | 30-00731-20 | 3 | Screw, 4-40 x 1/4", Phillips, pan head NOTE: For attaching serial controller. |
| 8 | 52-00004-02 | 1 | End cap, pen tray, right, silver |
| 9 | 30-00446-20 | 6 | Screw, 6-32 x 3/8", Phillips, pan head NOTE: For attaching pen tray end caps. |
| 10 | 30-457 | 4 | Bumper, rubber, black |
| 11 | FRU-PT10-SILVER | 1 | FRU, pen tray, silver NOTE: Controller not included. |
| Not shown | 93-00594-20 | 1 | Cable, ribbon, 13 1/2" (34 cm), pen tray to controller |
| Not shown | 03-00096-20 | 1 | Receiver, IR, wireless keyboard NOTE: For product with a serial number format that contains "R1" or "R2" |
| Not shown | 51-00035-20 | 1 | Bracket, pen tray and keyboard holder |
| Not shown | 30-00421-20 | 4 | Screw, 1/4"-20 x 3/8", Phillips, round head NOTE: Attaches pen tray to pen tray bracket. |

Accessory Kit (Part No. AK-00073-21)

| Part No. | Qty | Description |
|-------------|-----|--|
| 30-00122-20 | 5 | Anchor, self drilling, drywall NOTE: For installing the pen tray. |
| 30-369 | 5 | Screw, No. 8 × 1 1/4", Phillips, AB, truss head NOTE: For installing the pen tray. |
| 52-0015-00 | 2 | Grommet, cable |
| 60-00051-20 | 1 | Power supply, 12V DC, 5.0A, universal switching |
| 93-00370-20 | 1 | Cable, MOD8 to MOD8, 3'3" (99 cm), hub to controller |
| 93-00583-21 | 1 | Cable, USB, DB9 female to USB, 25' (7.6 m) NOTE: Does not provide power. |
| ERA-003 | 1 | Small eraser, comes with eraser barrier |
| RPEN | 1 | Pens - set of four (Black, Red, Blue, Green). Refer to product price list. |
| WM-00050-20 | 1 | Kit, hardware, for wall mount brackets |
| 93-068-00 | 2 | Cable, extension, PS/2 male to PS/2 female, 6' (1.8 m) |