

SMART™

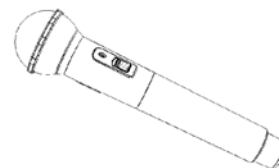
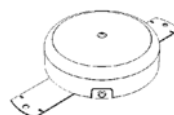
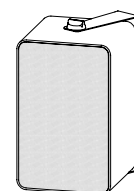
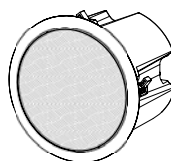
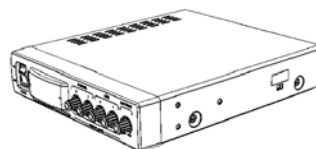

Service Parts Diagrams

**For Model:
CAS-240-W
CAS-240-C
CAS-SFP**

Service Parts Diagrams Revision History

Revision 1 - January, 2009

- New document

Revision 2 - May, 2009

- Change 01-00255 to 01-00269-20

Standard Warranty Terms

Base product: Two-year limited equipment warranty

Rechargeable NiMH microphone batteries: 30 day limited equipment warranty

First Customer Ship: September, 2008

SMART Technologies

3636 Research Road NW

Calgary, AB T2L 1Y1

CANADA

Support +1.403.228.5940 or Toll Free 1.866.518.6791 (Canada/U.S.)

Support Fax +1.403.806.1256

ServiceParts@smarttech.com www.smarttech.com



Service Parts Diagrams for the CAS-240-W, CAS-240-C and CAS-SFP

Identifying Your Product Using the Serial Number 1

Ordering Parts 1

CAS-240-C/CAS-240-W Parts 2

Optional SMART Audio Ceiling Speaker Fitting Plates (set of 4) (Part No. CAS-SFP) 3

Identifying Your Product Using the Serial Number

To make sure that you have the correct service parts diagrams, you must verify the serial number of your SMART Classroom Amplification System. The serial number is located on the bottom of the receiver. An example of the serial number format is shown below.

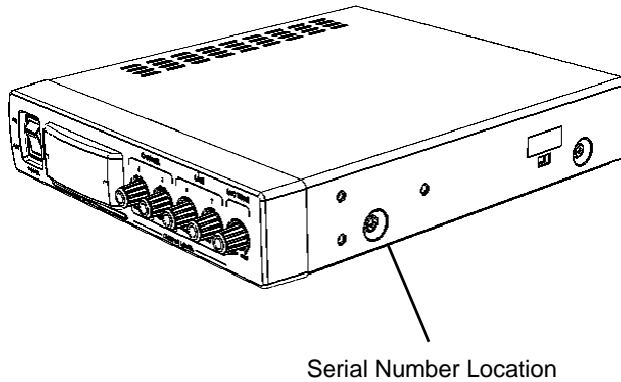

100301

Unique Serial Number

Ordering Parts

Customers

To order any of the parts in these service parts diagrams, contact your local reseller. To find a reseller near you, visit www.smarttech.com/where.

Dealers and Distributors

For specific technical and pricing enquiries in regards to these diagrams please contact our service parts department. Pricing is also available on-line via the SOURCE website (source.smarttech.com).

E-mail: serviceparts@smarttech.com
Phone: 1.888.42.SMART
International: +1.403.245.0333

CAS-240-C/CAS-240-W Parts

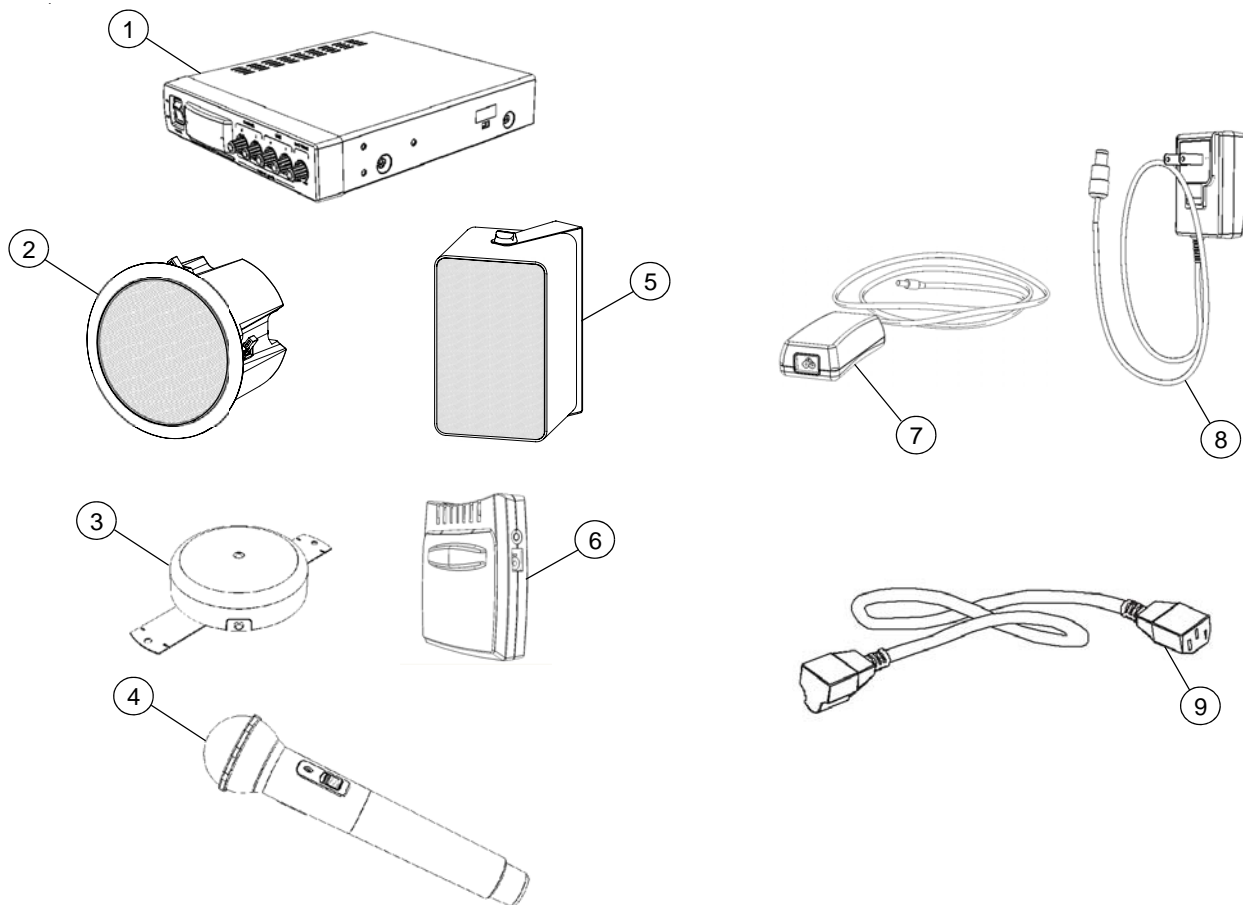

| Item | Part No. | Qty | Description |
|-----------|-------------|-----|--|
| 1 | 03-00115-20 | 1 | IR receiver |
| 2 | 03-00118-20 | 4 | Speaker, ceiling mount NOTE: Included with CAS-240-C only. |
| 3 | 03-00120-20 | 1 | IR sensor, ceiling |
| 4 | 03-00116-20 | 1 | Microphone, student |
| 5 | 03-00119-20 | 4 | Speaker, wall mount NOTE: Included with CAS-240-W only. |
| 6 | 03-00117-20 | 1 | Microphone, teacher |
| 7 | 60-00044-20 | 1 | Power supply, IR receiver, 15V DC, 2.7A, universal switching |
| 8 | 60-00047-20 | 2 | Power supply, student/teacher microphone, 6V DC, 1.0A, universal switching |
| 9 | 93-00671-20 | 1 | Cable, power, North America, 6' (1.8 m) |
| 9 | 93-00663-20 | 1 | Cable, power, United Kingdom, 6' 6" (2.0 m) |
| 9 | 93-00664-20 | 1 | Cable, power, Australia, 6' 6" (2.0 m) |
| 9 | 93-00665-20 | 1 | Cable, power, Europe, 6' 6" (2.0 m) |
| Not shown | 01-00269-20 | 4 | Battery, rechargeable, AA, Ni-MH |

Optional SMART Audio Ceiling Speaker Fitting Plates (set of 4) (Part No. CAS-SFP)

