

SMART™



Service Parts Diagrams

For Model:

FS640

FS670

Service Parts Diagrams Revision History

Revision 1 - February, 2010

- New document

Standard Warranty Terms

Base product: One-year limited equipment warranty

First Customer Ship: November, 2005

SMART Technologies

3636 Research Road NW
Calgary, AB T2L 1Y1
CANADA

Support +1.403.228.5940 or Toll Free 1.866.518.6791 (Canada/U.S.)

Support Fax +1.403.806.1256

ServiceParts@smarttech.com www.smarttech.com



Service Parts Diagrams for the FS640 and FS670

Ordering Parts 1

FS640 Parts (* indicates parts included in assembly hardware kit) 2

FS670 Parts (* indicates parts included in assembly hardware kit) 3

Ordering Parts

Customers

To order any of the parts in these service parts diagrams, contact your local reseller.
To find a reseller near you, visit www.smarttech.com/where.

Dealers and Distributors

For specific technical and pricing enquiries in regards to these diagrams please contact our service parts department.
Pricing is also available on-line via the SOURCE website (source.smarttech.com).

E-mail: serviceparts@smarttech.com
Phone: 1.888.42.SMART
International: +1.403.245.0333

FS640 Parts (* indicates parts included in assembly hardware kit)

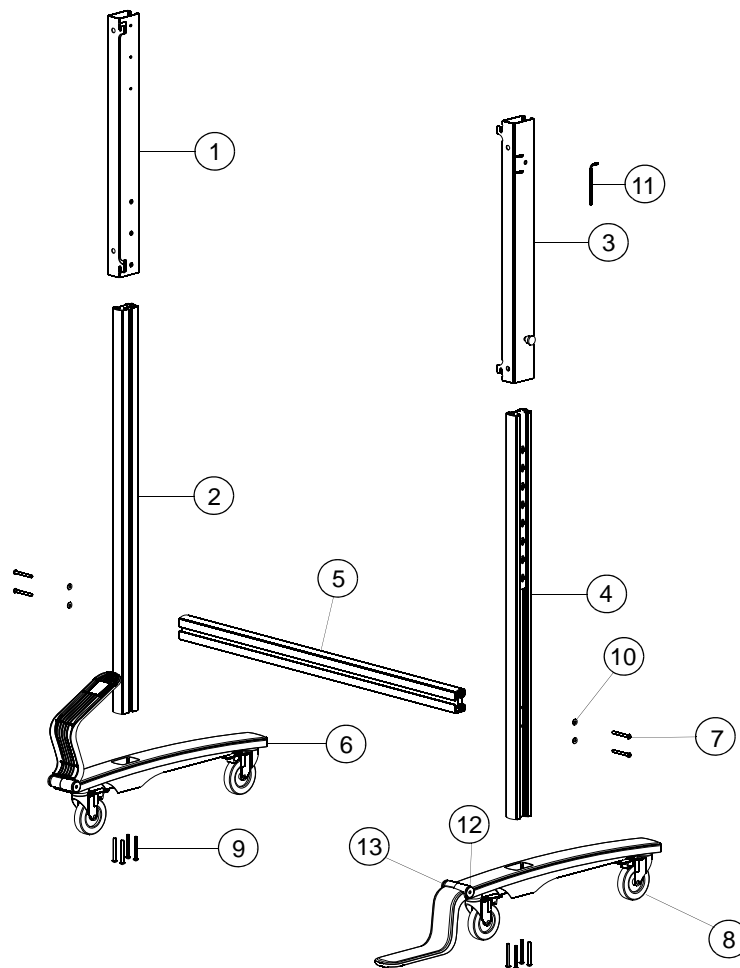

Item	Part No.	Qty	Description
1	20-00817-20	1	Bracket, height adjust, left, assembly, FS640
2	20-00819-20	1	Upright, left, assembly, FS640/FS670 NOTE: Order with 20-00818-20 for color match
3	20-00816-20	1	Bracket, height adjust, right, assembly, FS640
4	20-00818-20	1	Upright, right, assembly, FS640/FS670 NOTE: Order with 20-00819-20 for color match
5	51-00468-00	1	Cross member, extrusion, FS640
6	20-00820-20	2	Base, assembly, FS640/FS670 NOTE: Complete base foot assembly.
7*	30-01044-20	4	Screw, 1/4"-20 x 2 1/2", button head, hex, SEMS split washer
8	10-00021-20	4	Caster 4" (100 mm), swivel, locking
9*	30-01043-20	8	Screw, 1/4"-20 x 1 1/2", hex, button head, SEMS split washer
10*	30-01029-20	4	Washer, 5/16", flat
11*	78-018	1	Hex key, 5/32"
12	52-00320-00	2	Button, press, fit, base, FS6
13	52-00318-00	2	Button, press, fit, bolt, FS6 NOTE: For releasing tip foot.
14* Not shown	30-00981-20	4	Screw, 1/4"-20 x 5/8", hex, button head, SEMS NOTE: For attaching SMART Board to floor stand.
Not shown	20-01028-20	1	Kit, assembly hardware, FS640/FS670. NOTE: Contains items 7, 9, 10, 11, and 14.
Not shown	FRU-FS6CSK	1	FRU, FS640/FS670 replacement caster screw kit. NOTE: Screws for four casters.

FS670 Parts (* indicates parts included in assembly hardware kit)

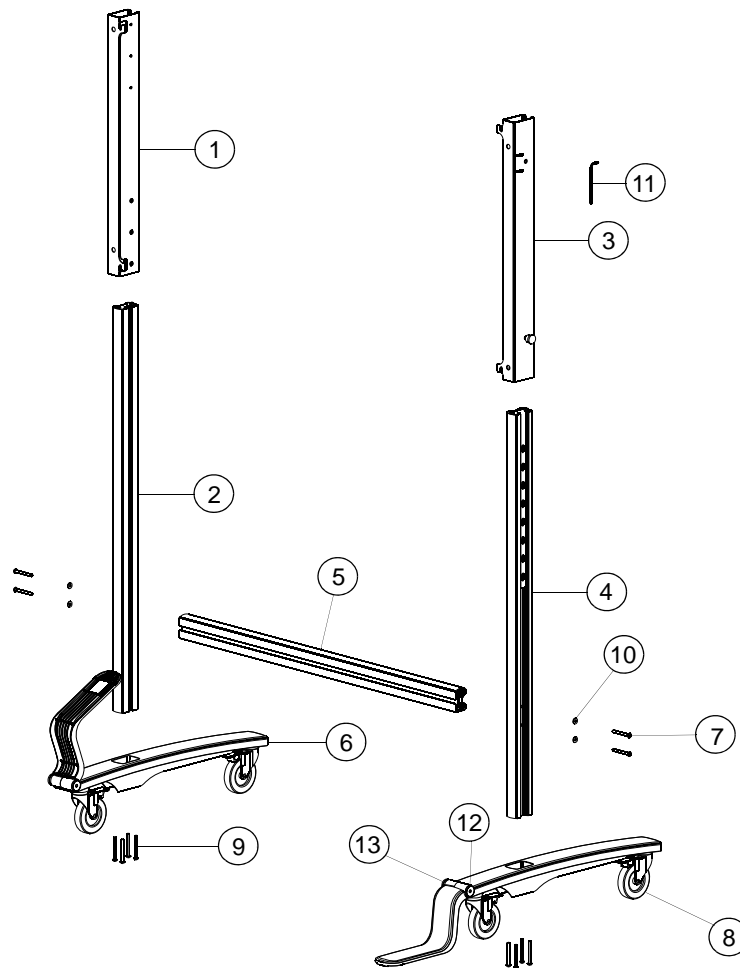

Item	Part No.	Qty	Description
1	20-00822-20	1	Bracket, height adjust, left, assembly, FS670
2	20-00819-20	1	Upright, left, assembly, FS640/FS670 NOTE: Order with 20-00818-20 for color match
3	20-00821-20	1	Bracket, height adjust, right, assembly, FS670
4	20-00818-20	1	Upright, right, assembly, FS640/FS670 NOTE: Order with 20-00819-20 for color match
5	51-00467-00	1	Cross member, extrusion, FS670
6	20-00820-20	2	Base, assembly, FS640/FS670 NOTE: Complete base foot assembly.
7*	30-01044-20	4	Screw, 1/4"-20 x 2 1/2", button head, hex, SEMS split washer
8	10-00021-20	4	Caster 4" (100 mm), swivel, locking
9*	30-01043-20	8	Screw, 1/4"-20 x 1 1/2", hex, button head, SEMS split washer
10*	30-01029-20	4	Washer, 5/16", flat
11*	78-018	1	Hex key, 5/32"
12	52-00320-00	2	Button, press, fit, base, FS6
13	52-00318-00	2	Button, press, fit, bolt, FS6 NOTE: For releasing tip foot.
14* Not shown	30-00981-20	4	Screw, 1/4"-20 x 5/8", hex, button head, SEMS NOTE: For attaching SMART Board to floor stand.
Not shown	20-01028-20	1	Kit, assembly hardware, FS640/FS670. NOTE: Contains items 7, 9, 10, 11, and 14.
Not shown	FRU-FS6CSK	1	FRU, FS640/FS670 replacement caster screw kit. NOTE: Screws for four casters.

