

**SMART<sup>®</sup>**

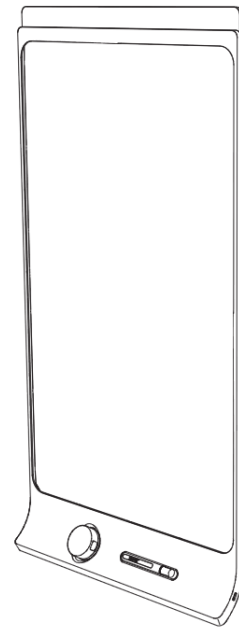

## ***Service Parts Diagrams***

**For Model:  
KAPP42**

## Service Parts Diagrams Revision History

### Revision 1 - December, 2014

- New document

### Revision 2 - June, 2015

- Add warranty information for the UK and Europe

### Revision 3 - February, 2016

- Revise warranty for North America to one-year and add reference to LATAM and APAC

### Revision 4 - January, 2018

- Remove 1024568
- Add 1026779

## Standard Warranty Terms

Base product:

North America and the rest of the world - One-year limited equipment warranty  
EMEA - Two-year limited equipment warranty

First Customer Ship: November, 2014

---

#### SMART Technologies

3636 Research Road NW  
Calgary, AB T2L 1Y1  
CANADA

Support +1.403.228.5940 or Toll Free 1.866.518.6791 (Canada/U.S.)

Support Fax +1.403.806.1256

[www.smarttech.com/contactserviceparts](http://www.smarttech.com/contactserviceparts) [www.smarttech.com](http://www.smarttech.com)



# Service Parts Diagrams for the KAPP42

---

Identifying Your Product Using the Serial Number .....	1
Ordering Parts .....	1
KAPP42 Parts .....	2



## Identifying Your Product Using the Serial Number

To make sure that you have the correct service parts diagrams, you must verify the serial number of your KAPP42. The serial number will be located on the back of the board. An example of the serial number format is shown below.



## Ordering Parts

### Customers

To order any of the parts in these service parts diagrams, contact your local reseller.  
To find a reseller near you, visit [www.smarttech.com/where](http://www.smarttech.com/where).

### Dealers and Distributors

For specific technical and pricing enquiries in regards to these diagrams please contact our service parts department.  
Pricing is also available on-line via the SOURCE website ([source.smarttech.com](http://source.smarttech.com)).

Web Form: [www.smarttech.com/contactserviceparts](http://www.smarttech.com/contactserviceparts)  
Phone: 1.888.42.SMART  
International: +1.403.245.0333

KAPP42 Parts

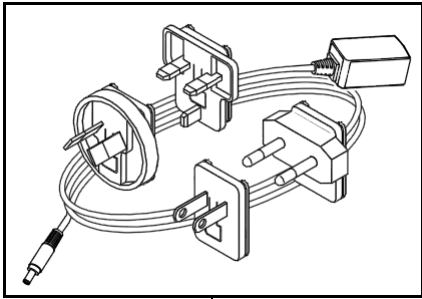

1

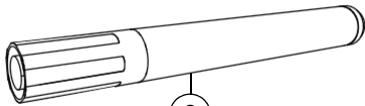

2

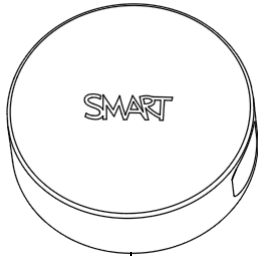

3

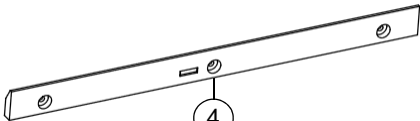

4

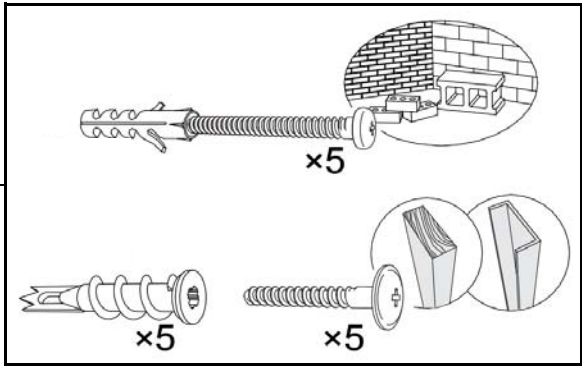

5

Item	Part No.	Qty	Description
1	1026779	1	Power supply kit, 5V DC, 3.0A, universal switching <b>NOTE:</b> Includes plug adapters for North America, Europe, United Kingdom and Australia.
2	RPEN-KAPP	1	Replacement Pens for KAPP - Set of Three
3	RERASER-KAPP42	1	Replacement Eraser for KAPP42
4	1024560	1	Assembly, Bracket, Wall Mount, KAPP42
5	1024563	1	Assembly, Mounting Hardware, KAPP42