

SMART[®]

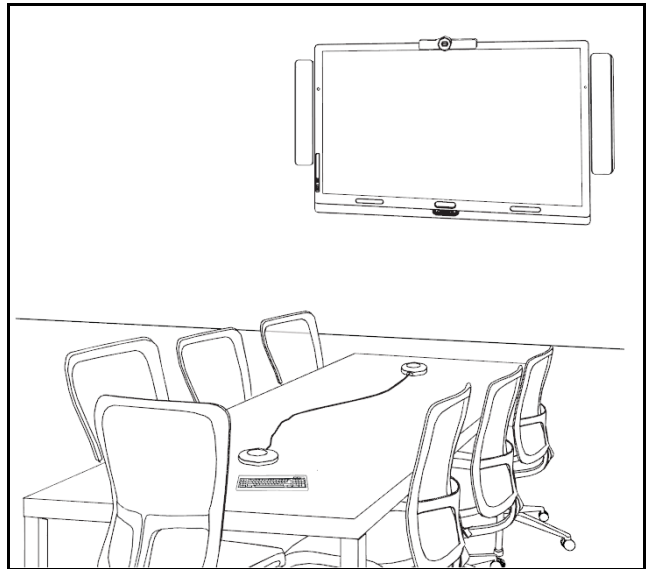

Service Parts Diagrams

**For Model:
SRS-MP-170**

Service Parts Diagrams Revision History

Revision 1 - December, 2014

- New document

Revision 2 - July, 2015

- Add FRU-SBID-G4-CSM-2
- Change 1023793 to 1024914
- Change quantity for 1019440 to 1

Standard Warranty Terms

Base product: Two-year limited equipment warranty

First Customer Ship: December, 2014

SMART Technologies

3636 – Research Road NW
Calgary, AB T2L 1Y1
CANADA

Support +1.403.228.5940 or Toll Free 1.866.518.6791 (Canada/U.S.)

Support Fax +1.403.806.1256

www.smarttech.com/contactserviceparts www.smarttech.com



Service Parts Diagrams for the SRS-MP-170

- Identifying Your Product Using the Serial Number 1
- Ordering Parts 1
- SBID8070i-G4-SMP Parts 2
- Assembly, Speakers, CSR500 (Part No. 1017846) 4
- Assembly, Camera, CAM301 (Part No. 1019674) 5
- Kit, SMART Room System with Meeting Pro, Accessory and Documentation
(Part No. SRS-MP-KIT) 6
- Assembly, Monaural Audio System (Part No. 1018285) 7
- Wall Mount, SBID8070i-G4 (Part No. WM-SBID-501) 8
- Optional Wall Stand Kit for Single Integrated Flat Panel (Part No. WSK-SINGLE) 9

Identifying Your Product Using the Serial Number

Each of the major components of your system has a serial number:

Component	Serial number location
Interactive flat panel	Left underside of the pen ledge NOTES: - When requesting technical support, provide SMART support with the interactive panel's serial number. - You can also access the interactive flat panel's serial number from the on-screen display menu.
Camera	Top of the camera beside the service light
Audio processor	Narrow side of the audio processor
Speakers	Back of each speaker

Ordering Parts

Customers

To order any of the parts in these service parts diagrams, contact your local reseller.
To find a reseller near you, visit www.smarttech.com/where.

Dealers and Distributors

For specific technical and pricing enquiries in regards to these diagrams please contact our service parts department.
Pricing is also available on-line via the SOURCE website (source.smarttech.com).

Web Form: www.smarttech.com/contactserviceparts
Phone: 1.888.42.SMART
International: +1.403.245.0333

SBID8070i-G4-SMP Parts

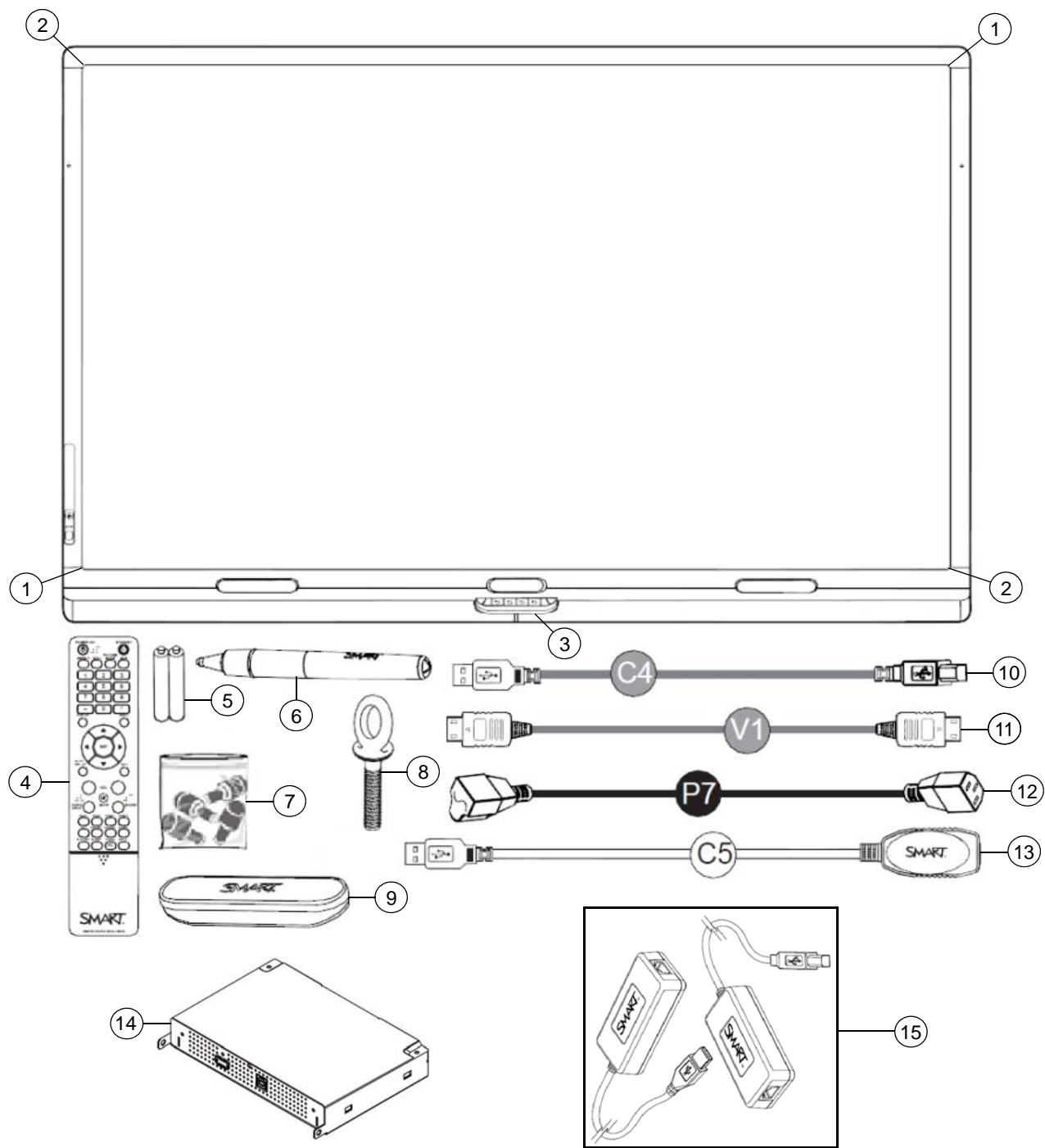

Item	Part No.	Qty	Description
1	FRU-SBID-G4-CAM-A	2	FRU, camera A, SBID-G4, position 0 and 2
2	FRU-SBID-G4-CAM-B	2	FRU, camera B, SBID-G4, position 1 and 3

3	FRU-SBID-G4-CSM	1	FRU, Color Select Module (CSM), SBID-G4, Revision 1 NOTE: This is compatible with the following serial number sequences: The fifth character is the letter "G" and the seventh/eighth character is the number "41" or lower (example K012 <u>G</u> <u>W</u> 41F0001). OR The fifth character is the letter "F" or lower in the alphabet (example K012 <u>F</u> <u>W</u> 01F0001).
3	FRU-SBID-G4-CSM-2	1	FRU, Color Select Module (CSM), SBID-G4, Revision 2 NOTE: This is compatible with the following serial number sequences: The fifth character is the letter "G" and the seventh/eighth character is the number "42" or higher (example K012 <u>G</u> <u>W</u> 42F0001). OR The fifth character is the letter "H" or higher in the alphabet (example K012 <u>H</u> <u>W</u> 01F0001).
4	1020371	1	Assembly, remote control, SBID8070i-G4
5	01-00257	2	Battery, AAA
6	RPEN-SBID	2	Assembly, stylus NOTE: Includes set of four spare pen nibs.
7	FRU-NIB-SBID	1	Replacement Nibs for the SMART Board Interactive Display Pen - Set of Four
8	30-01448-20	2	Eye bolt NOTE: Required only when lifting the display.
9	RERASER-SBID	1	Assembly, eraser
10	1019521	1	Cable, USB, A-B, 4' 3" (1.3 m)
11	1019416	1	Cable, HDMI male to HDMI male, 20' 8" (6.3 m)
12	1022063	1	Cable, power, North America, 8' (2.4 m)
12	93-055	1	Cable, power, United Kingdom, 8' (2.4 m)
12	93-056	1	Cable, power, Australia, 8' (2.4 m)
12	93-054	1	Cable, power, Europe, 8' (2.4 m)
12	93-00708-20	1	Cable, power, China, 8' (2.4 m)
12	93-00654-20	1	Cable, power, Japan, 8' (2.4 m)
13	USB-XT	1	USB active extension cable 16' (5.0 m)
14	SBID-G4-XTM	1	FRU, XTM (Slave Panel Interface Board, SPIB), SBID-G4
15	CAT5-XT-1100	1	CAT 5 to USB Extender, CAT5 Cable not included

Assembly, Speakers, CSR500 (Part No. 1017846)

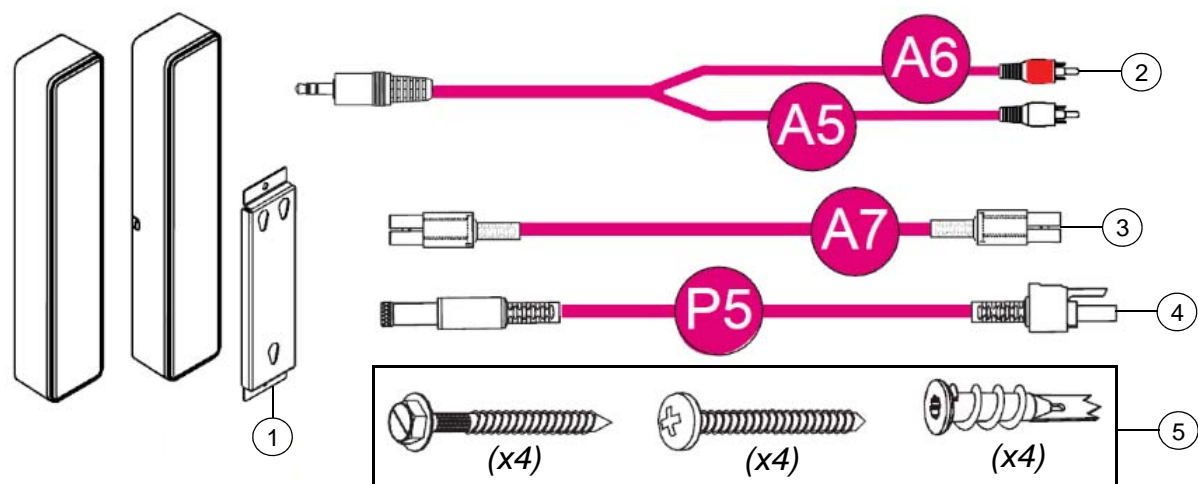

Item	Part No.	Qty	Description
1	1021019	2	Assembly, mounting bracket kit, CSR500
2	1019133	1	Cable, audio, 3.5 mm male to dual RCA male, 1' 7" (50 cm) NOTE: Not used in a SRS-MP installation.
3	1019132	1	Cable, audio, left to right speaker, 16' (5.0 m)
4	1019134	1	Cable, power, 1' 7" (50 cm) NOTE: Not used in a SRS-MP installation.
5	1021002	1	Assembly, hardware, kit, CSR500

Assembly, Camera, CAM301 (Part No. 1019674)

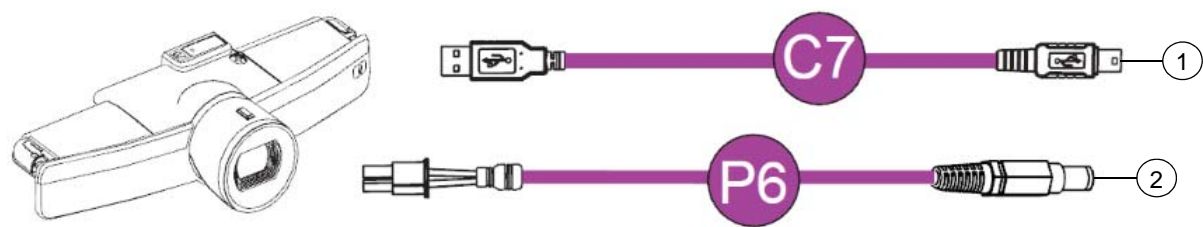

Item	Part No.	Qty	Description
1	1020902	1	Cable, USB A to USB Mini-B, 9' 10" (3.0 m) NOTE: Not used in a SRS-MP installation.
2	1020900	1	Cable, power, 4' 7" (1.4 m)

Kit, SMART Room System with Meeting Pro, Accessory and Documentation **(Part No. SRS-MP-KIT)**

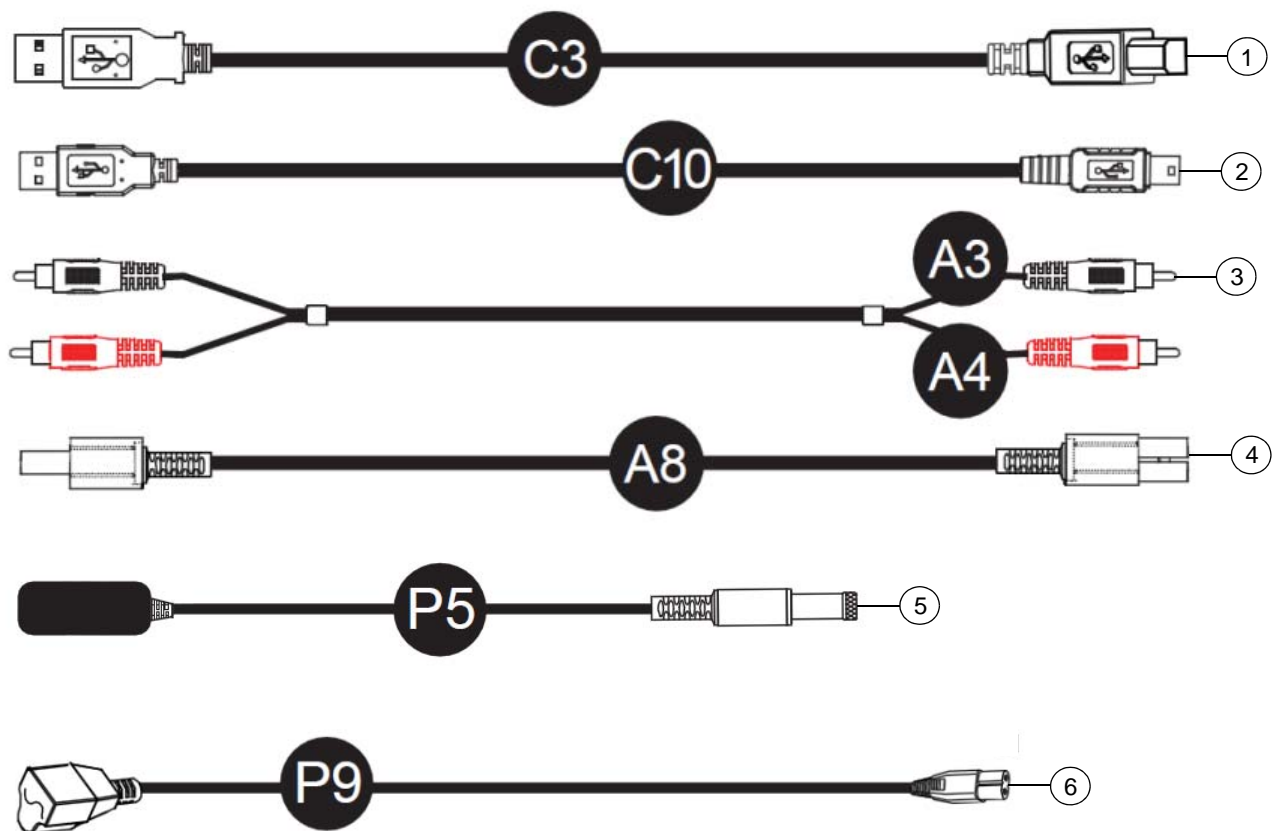

Item	Part No.	Qty	Description
1	93-00828-20	1	Cable, USB, A-B, 16' (5.0 m), SBX8
2	1018744	1	Cable, USB A to USB Mini-B, 16' (5.0 m)
3	1024906	1	Cable, audio, dual RCA to dual RCA, 11' 6" (3.5 m)
4	1024962	1	Cable, analog audio, Molex female to Molex male, 4' 11" (1.5 m) NOTE: Not used in a SRS-MP-170 installation.
5	1024914	1	Power supply, 19V DC, 3.0A, universal switching
6	93-00592-20	1	Cable, power, North America, 6' 6" (2.0 m)
6	93-00542-20	1	Cable, power, Europe, 6' 6" (2.0 m)
6	93-00543-20	1	Cable, power, United Kingdom, 6' 6" (2.0 m)
6	93-00806-20	1	Cable, power, China, 6' 6" (2.0 m)
6	93-00576-20	1	Cable, power, Australia, 6' 6" (2.0 m)
6	1023214	1	Cable, power, Japan, 6' 6" (2.0 m)

Assembly, Monaural Audio System (Part No. 1018285)

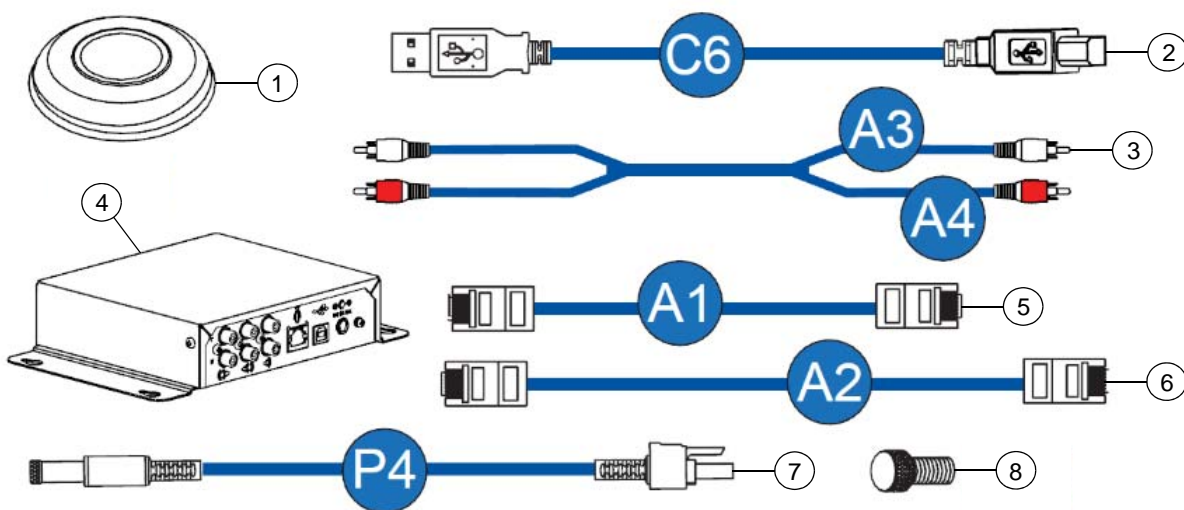

Item	Part No.	Qty	Description
1	MIC500	2	Microphone for SMART Room System NOTE: Includes item 5.
2	1020351	1	Cable, USB, A-B, 6' (1.8 m) NOTE: Not used in a SRS-MP installation.
3	1020352	1	Cable, audio, dual RCA to dual RCA, 6' (1.8 m) NOTE: Not used in a SRS-MP installation.
4	1018756	1	Assembly, FRU, Processor, Monaural Audio, MIX500
5	1019752	1	Cable, RJ45 to RJ45, 13' 1" (4.0 m)
6	1019739	1	Cable, RJ45 to RJ45, 29' 6" (9.0 m)
7	1020353	1	Cable, power, 1' 7" (50 cm)
8	1019440	1	Screw, thumb, M4 x 5 mm, Phillips (set of four)

Wall Mount, SBID8070i-G4 (Part No. WM-SBID-501)

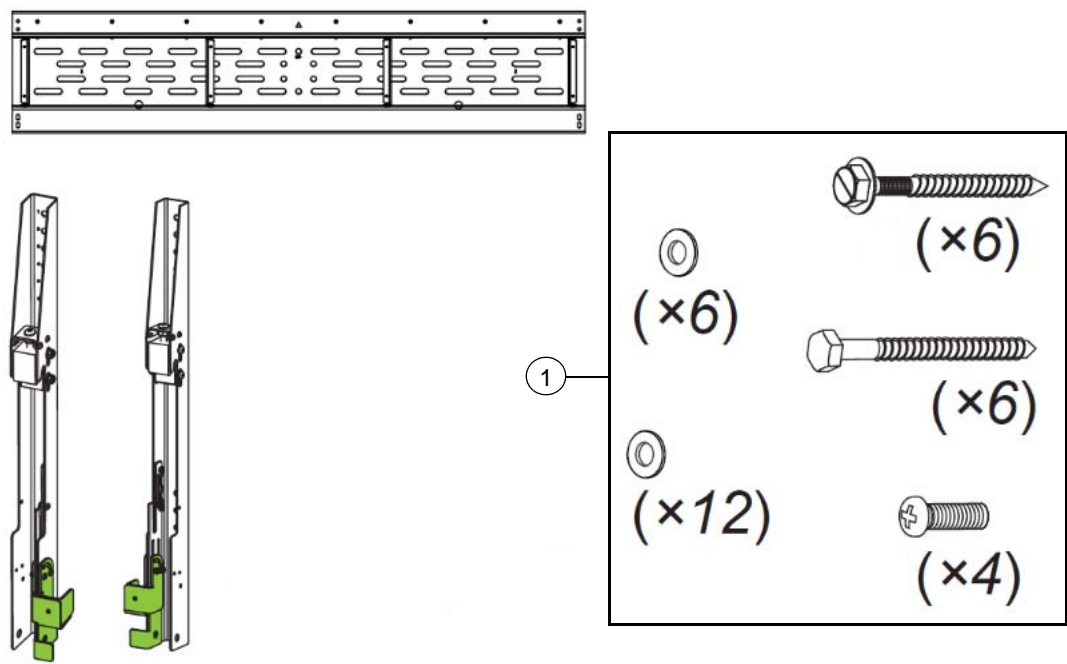

Item	Part No.	Qty	Description
1	1022216	1	Assembly, hardware, kit, WM-SBID-501/502

Optional Wall Stand Kit for Single Integrated Flat Panel (Part No. WSK-SINGLE)

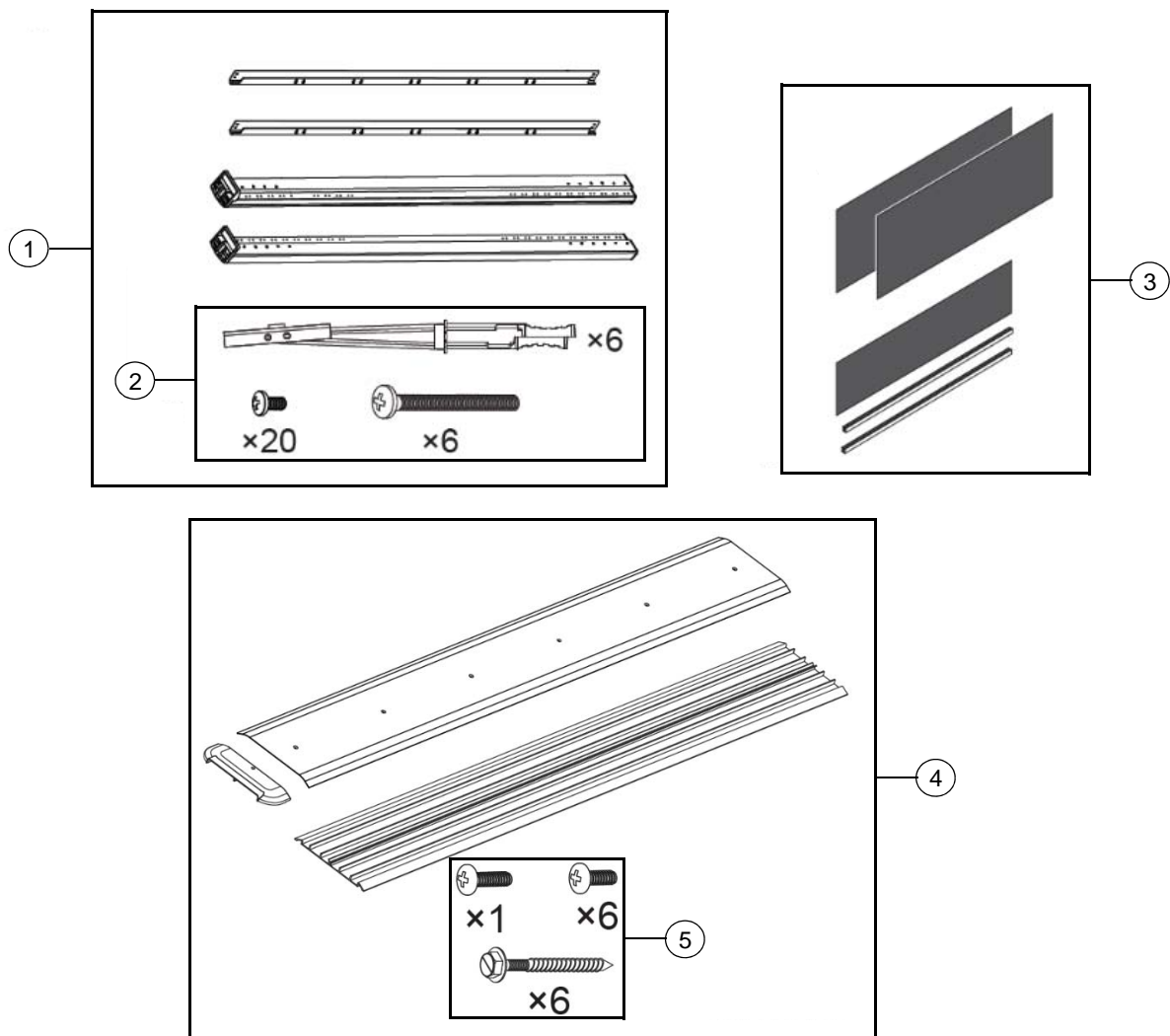

Item	Part No.	Qty	Description
1	1020547	1	Assembly, uprights, wall stand NOTE: Includes item 2.
2	1021347	1	Assembly, hardware, kit, WS-SBID-500
3	1020546	2	Assembly, panel, wall stand
4	1018900	1	Assembly, cable raceway, RW-500 NOTE: Includes item 5.
5	1021406	1	Assembly, hardware, kit, RW-500