

WS-SBID-500

WS-SBID-500

smarttech.com/kb/170466

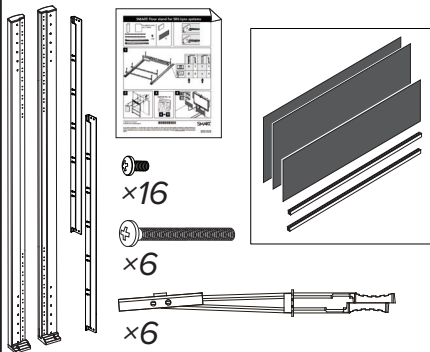

WM-SBID-501

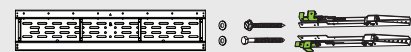

SBID8055i



SBID8065i-G5



SBID8055i-G5



SBID8070i-G4



1

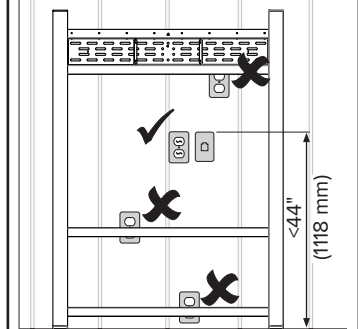

2

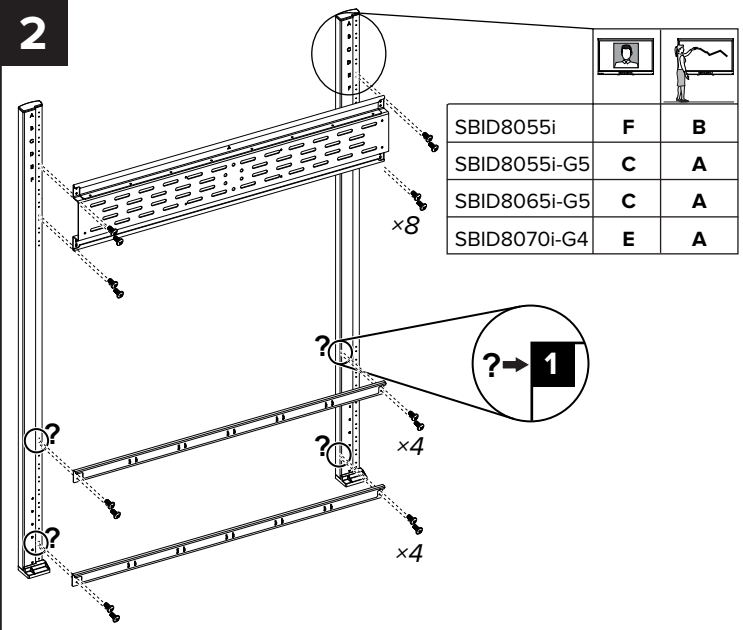

3

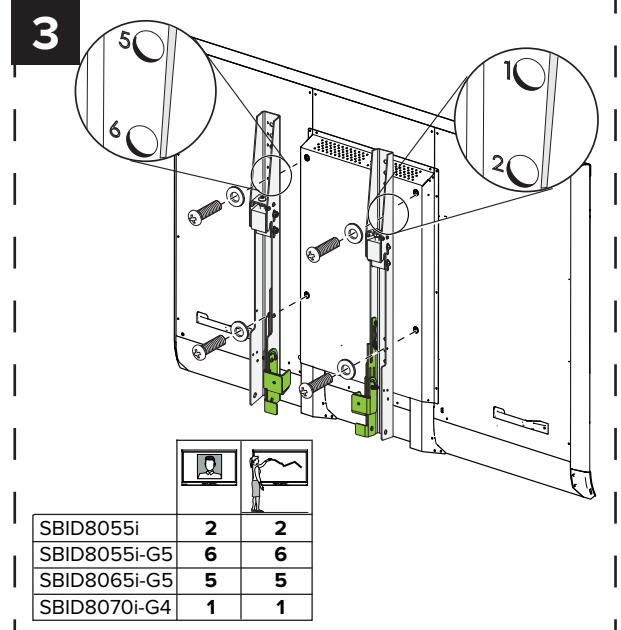

4

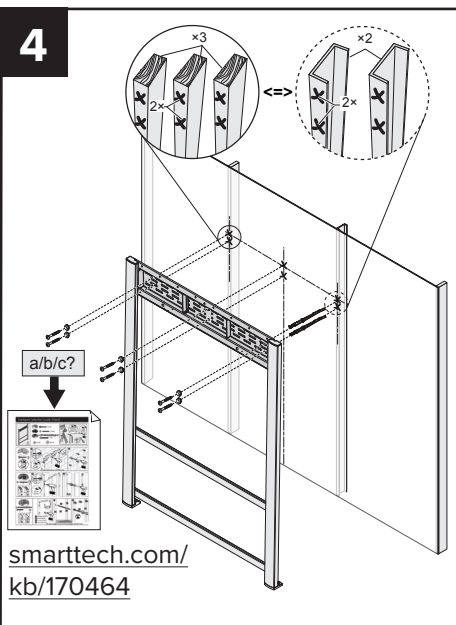

smarttech.com/kb/170464

5

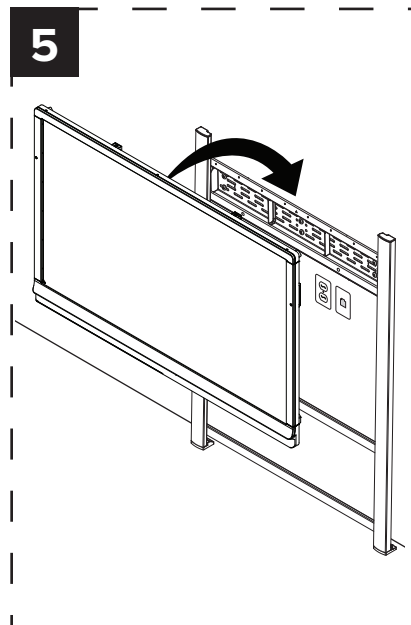

6

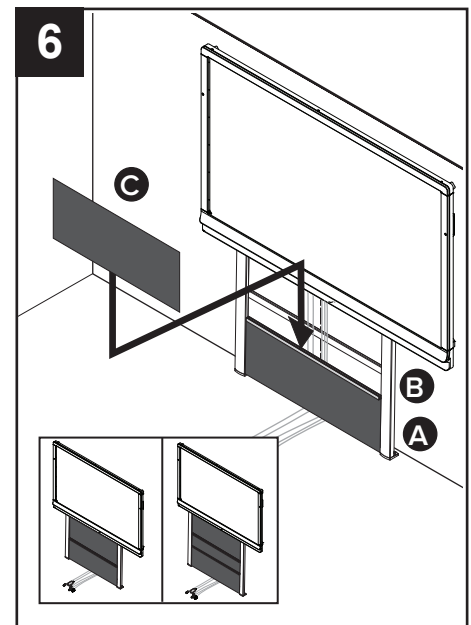

CAUTION: This wall mount or stand is intended for use with a display system with a maximum weight of 276 lb. (125 kg) and a maximum diagonal of 84" (214 cm). Use with products that are heavier than the maximum weight indicated may cause the mount and its accessories to collapse, resulting in possible personal injury.

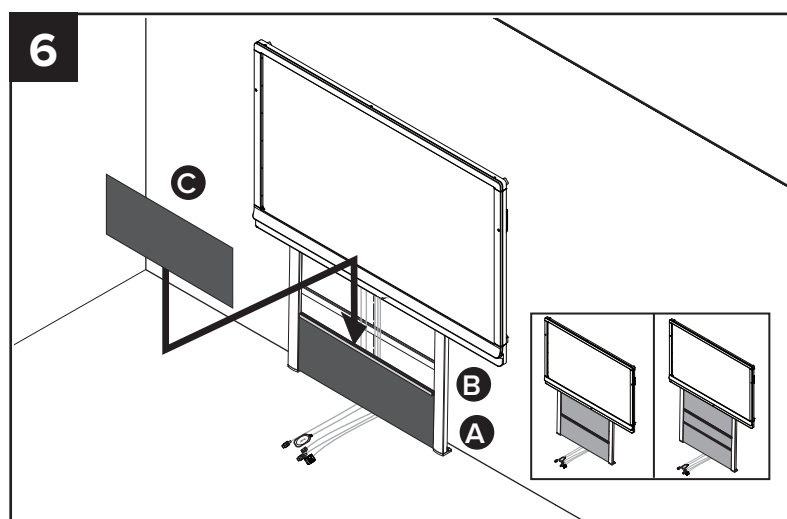
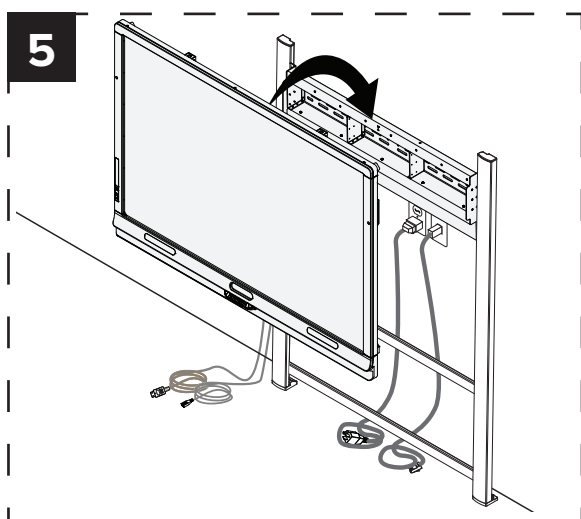
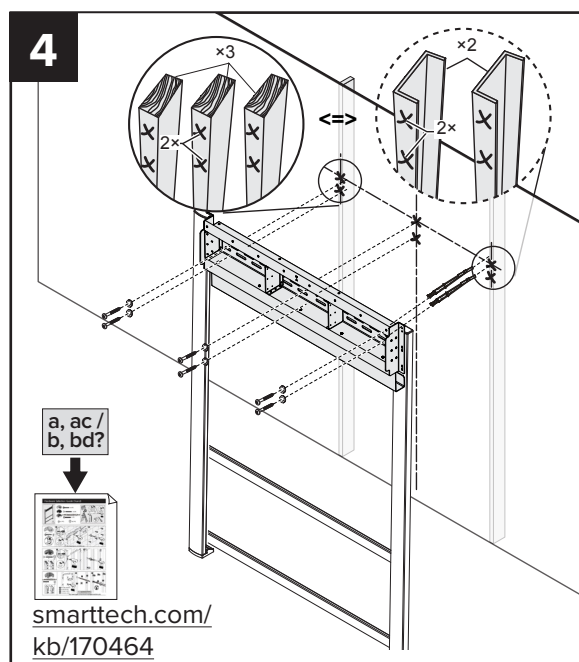
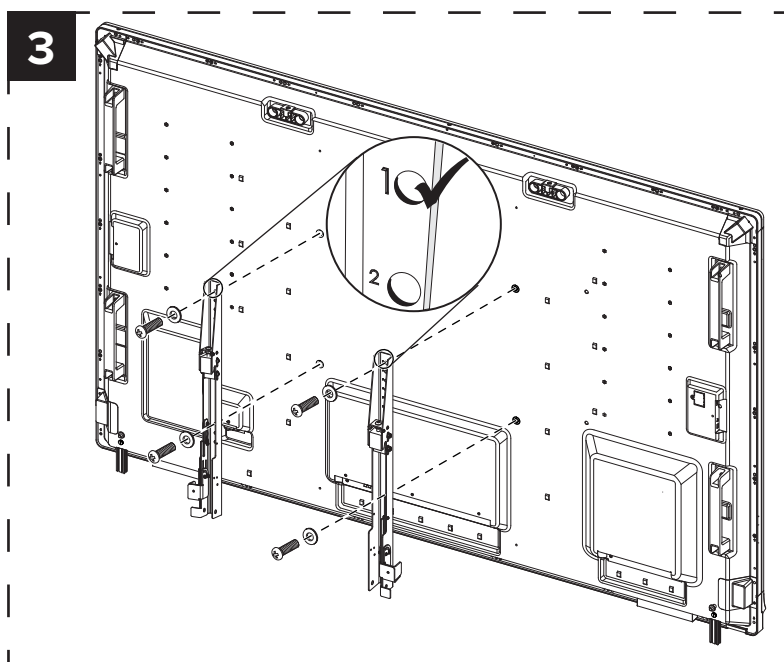
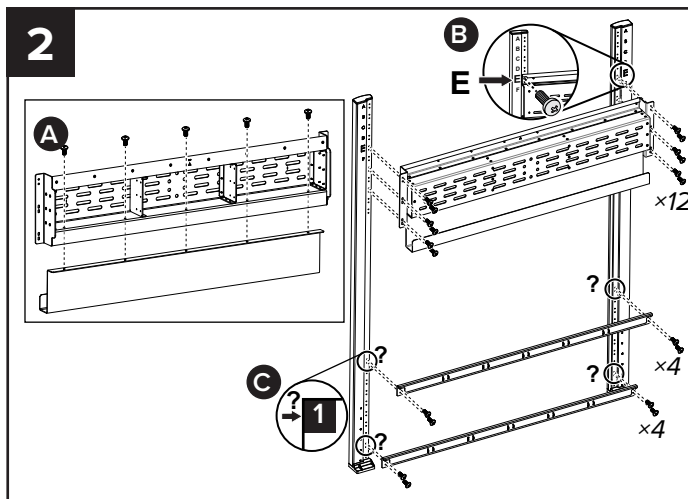
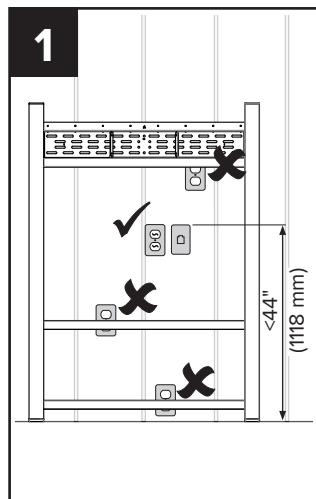
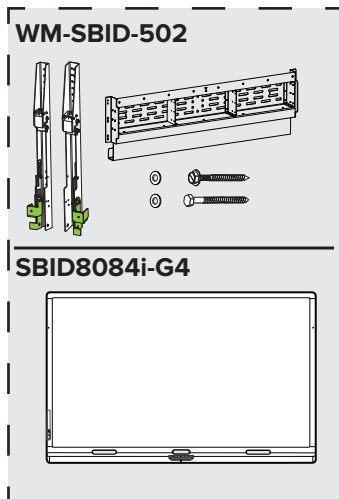

CAUTION: This wall mount or stand is intended for use with a display system with a maximum weight of 276 lb. (125 kg) and a maximum diagonal of 84" (214 cm). Use with products that are heavier than the maximum weight indicated may cause the mount and its accessories to collapse, resulting in possible personal injury.



smarttech.com/support
smarttech.com/contactsupport

SMART

© 2014 SMART Technologies ULC. All rights reserved. SMART Board, smarttech, the SMART logo and all SMART taglines are trademarks or registered trademarks of SMART Technologies ULC in the U.S. and/or other countries. All third-party products and company names may be trademarks of their respective owners. Contents are subject to change without notice. This product and/or use thereof covered by one or more of the following U.S. patents; smarttech.com/patents. Other patents pending. 12/2014.

1020412 Rev 07