

# SMART<sup>®</sup>



## ***Service Parts Diagrams***

**For Model:  
SBID-7275**

## Service Parts Diagrams Revision History

### Revision 1 - June, 2017

- New document

### Revision 2 - May, 2018

- Add 1030586, 1030594, 1030595 and 1030596

### Revision 3 - June, 2019

- Remove 1029766

## Standard Warranty Terms

Base product: Three-year limited equipment warranty

First Customer Ship: June, 2017

---

#### SMART Technologies

3636 – Research Road NW  
Calgary, AB T2L 1Y1  
CANADA

Support +1.403.228.5940 or Toll Free 1.866.518.6791 (Canada/U.S.)

Support Fax +1.403.806.1256

[www.smarttech.com/contactserviceparts](http://www.smarttech.com/contactserviceparts) [www.smarttech.com](http://www.smarttech.com)



# Service Parts Diagrams for the SBID-7275

---

Identifying Your Product Using the Serial Number .....	1
Ordering Parts .....	1
SBID-7275 Parts .....	2



## Identifying Your Product Using the Serial Number

To make sure that you have the correct service parts diagrams, you must verify the serial number of your SBID-7275. The serial number of the flat panel display will be located on the right underside of the bottom bezel. The serial number of the AM30/AM40 will be located on either the top or bottom of the appliance. An example of the serial number format is shown below.



Serial Number Location

Unique Serial Number

**K012JW24W0003**

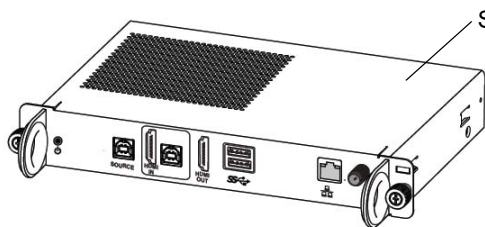

Serial Number Location

Unique Serial Number

**Q022JW02B0545**

**OR**

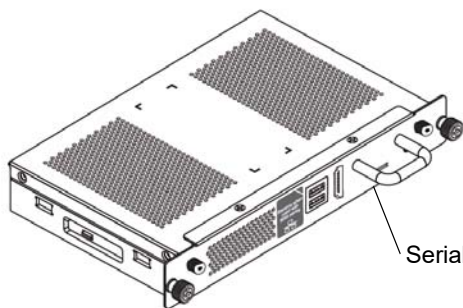

Serial Number Location

Unique Serial Number

**F102JW27B00111**

## Ordering Parts

### Customers

To order any of the parts in these service parts diagrams, contact your local reseller. To find a reseller near you, visit [www.smarttech.com/where](http://www.smarttech.com/where).

### Dealers and Distributors

For specific technical and pricing enquiries in regards to these diagrams please contact our service parts department. Pricing is also available on-line via the SOURCE website ([source.smarttech.com](http://source.smarttech.com)).

Web Form: [www.smarttech.com/contactserviceparts](http://www.smarttech.com/contactserviceparts)  
Phone: 1.888.42.SMART  
International: +1.403.245.0333

## SBID-7275 Parts

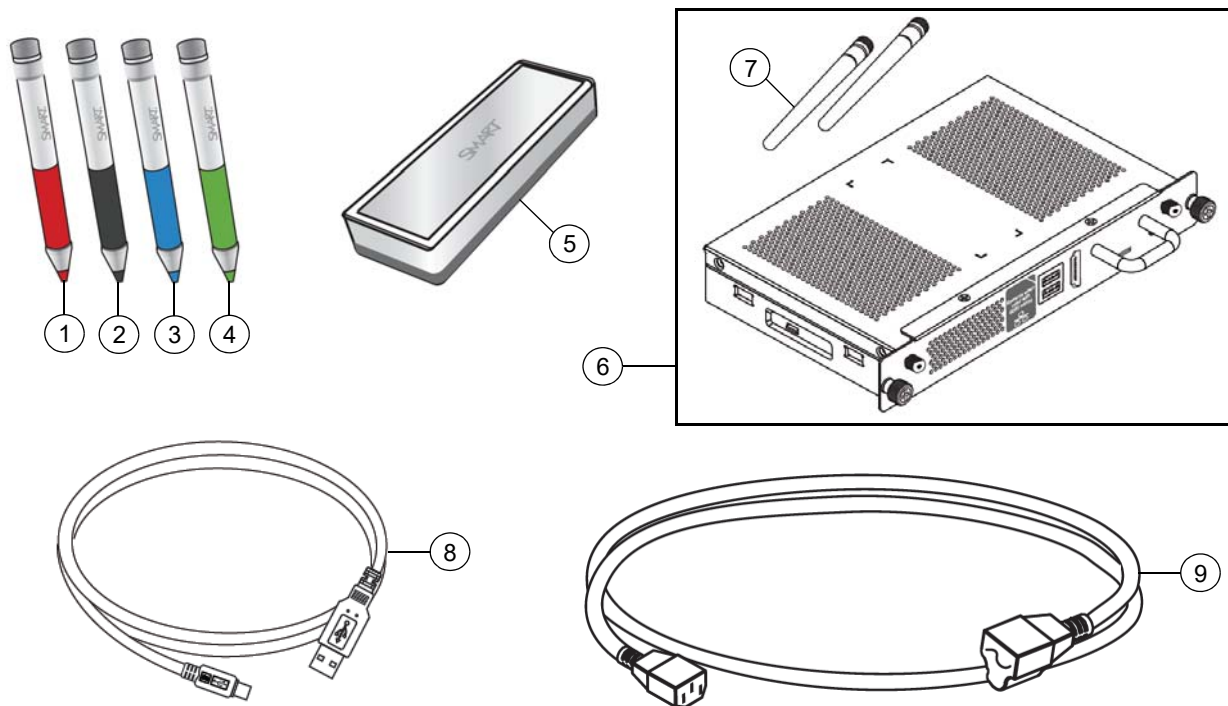

Item	Part No.	Qty	Description
1	1030594	1	Assembly, active stylus, red, single pack
2	1030586	1	Assembly, active stylus, black, single pack
3	1030596	1	Assembly, active stylus, blue, single pack
4	1030595	1	Assembly, active stylus, green, single pack
5	1028732	1	Assembly, eraser
6	UGK-AM40-EDU	1	Appliance for Education for SMART Board 6000/7000 Series interactive flat panels <b>NOTE:</b> Includes AM40 and 2 pieces of item 7. <b>NOTE:</b> This is to replace AM30's that have a part number of C1028544 or AM40's that have a part number of 1029788.
7	1029824	2	Antenna
8	1028289	1	Cable, USB, A-B, 16' (5.0 m)
9	1022063	1	Cable, power, North America, 8' (2.4 m)
9	93-055	1	Cable, power, United Kingdom, 8' (2.4 m)
9	93-056	1	Cable, power, Autstralia, 8' (2.4 m)
9	93-054	1	Cable, power, Europe, 8' (2.4 m)
9	93-00708-20	1	Cable, power, China, 8' (2.4 m)
9	93-00654-20	1	Cable, power, Japan, 8' (2.4 m)
9	93-063	1	Cable, power, South Africa, 8' (2.4 m)
9	1018969	1	Cable, power, Singapore, 14' 9" (4.5 m)
9	1018970	1	Cable, power, India, 14' 9" (4.5 m)
9	1018971	1	Cable, power, Saudi Arabia, 14' 9" (4.5 m)
9	1018972	1	Cable, power, Brazil, 14' 9" (4.5 m)
9	1025597	1	Cable, power, Argentina, 14' 9" (4.5 m)

9	1025603	1	Cable, power, Chile and Italy, 14' 9" (4.5 m)
9	1030859	1	Cable, power, Korea, 8' (2.4 m)
Not shown	1029567	1	Kit, packaging, SBID-7275