

SMART[®]



Service Parts Diagrams

**For Model:
SBID-7286**

Service Parts Diagrams Revision History

Revision 1 - December, 2017

- New document

Revision 2 - May, 2018

- Add 1030586, 1030594, 1030595 and 1030596

Revision 3 - July, 2019

- Remove 1029766

Standard Warranty Terms

Base product: Three-year limited equipment warranty

First Customer Ship: September, 2017

SMART Technologies

3636 – Research Road NW
Calgary, AB T2L 1Y1
CANADA

Support +1.403.228.5940 or Toll Free 1.866.518.6791 (Canada/U.S.)

Support Fax +1.403.806.1256

www.smarttech.com/contactserviceparts www.smarttech.com



Service Parts Diagrams for the SBID-7286

Identifying Your Product Using the Serial Number 1

Ordering Parts 1

SBID-7286 Parts 2

Identifying Your Product Using the Serial Number

To make sure that you have the correct service parts diagrams, you must verify the serial number of your SBID-7286. The serial number of the flat panel display will be located on the right underside of the bottom bezel. The serial number of the AM40 will be located on the bottom of the appliance. An example of the serial number format is shown below.

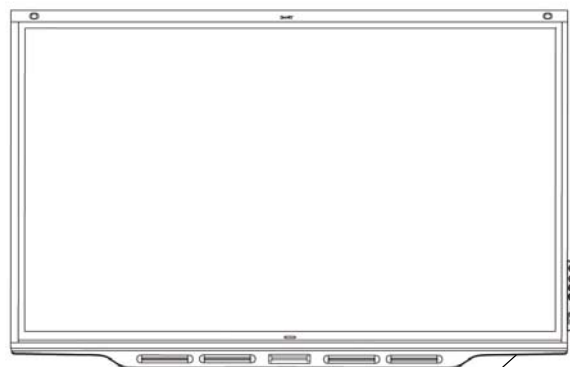

Serial Number Location

Unique Serial Number

K012JW47Z0045

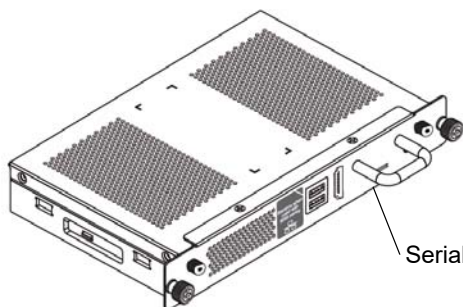

Serial Number Location

Unique Serial Number

F102JW27B00111

Ordering Parts

Customers

To order any of the parts in these service parts diagrams, contact your local reseller. To find a reseller near you, visit www.smarttech.com/where.

Dealers and Distributors

For specific technical and pricing enquiries in regards to these diagrams please contact our service parts department. Pricing is also available on-line via the SOURCE website (source.smarttech.com).

Web Form: www.smarttech.com/contactserviceparts
Phone: 1.888.42.SMART
International: +1.403.245.0333

SBID-7286 Parts

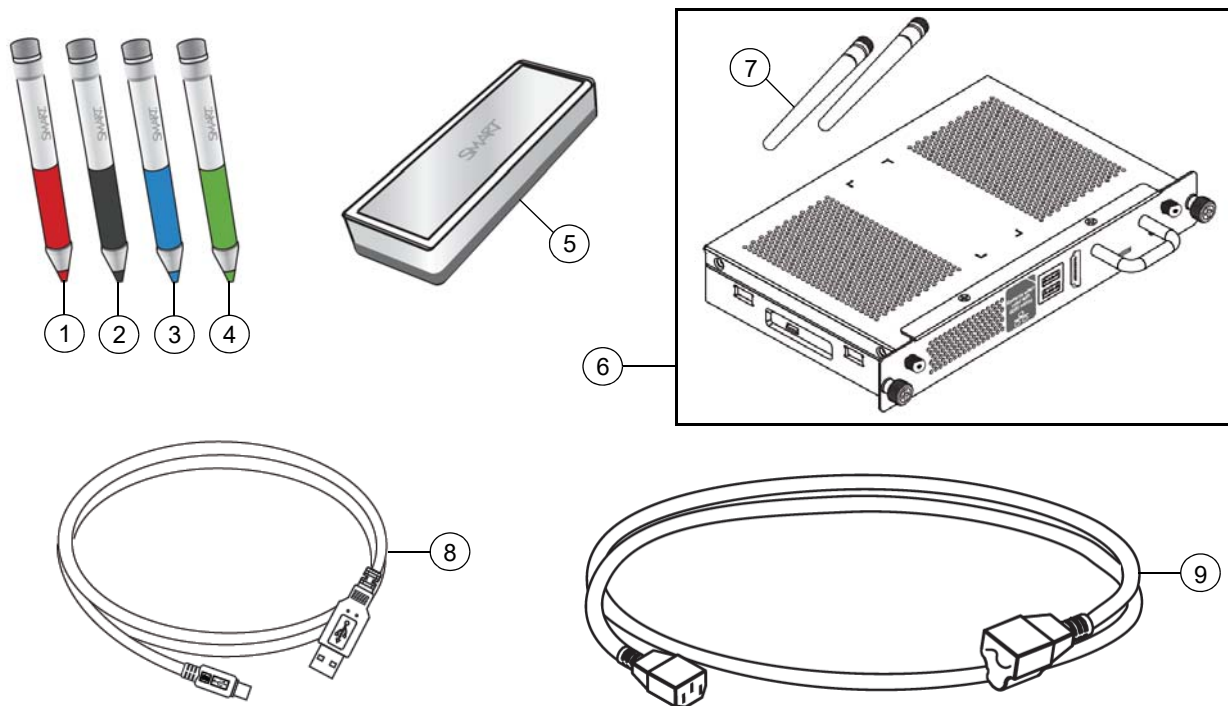

Item	Part No.	Qty	Description
1	1030594	1	Assembly, active stylus, red, single pack
2	1030586	1	Assembly, active stylus, black, single pack
3	1030596	1	Assembly, active stylus, blue, single pack
4	1030595	1	Assembly, active stylus, green, single pack
5	1028732	1	Assembly, eraser
6	UGK-AM40-EDU	1	Appliance for Education for SMART Board 6000/7000 Series interactive flat panels NOTE: Includes AM40 and 2 pieces of item 7. NOTE: This is to replace AM30's that have a part number of C1028544 or AM40's that have a part number of 1029788.
7	1029824	2	Antenna
8	1028289	1	Cable, USB, A-B, 16' (5.0 m)
9	1022063	1	Cable, power, North America, 8' (2.4 m)
9	93-055	1	Cable, power, United Kingdom, 8' (2.4 m)
9	93-056	1	Cable, power, Australia, 8' (2.4 m)
9	93-054	1	Cable, power, Europe, 8' (2.4 m)
9	93-00708-20	1	Cable, power, China, 8' (2.4 m)
9	93-00654-20	1	Cable, power, Japan, 8' (2.4 m)
9	93-063	1	Cable, power, South Africa, 8' (2.4 m)
9	1018969	1	Cable, power, Singapore, 14' 9" (4.5 m)
9	1018970	1	Cable, power, India, 14' 9" (4.5 m)
9	1018971	1	Cable, power, Saudi Arabia, 14' 9" (4.5 m)
9	1018972	1	Cable, power, Brazil, 14' 9" (4.5 m)
9	1025597	1	Cable, power, Argentina, 14' 9" (4.5 m)

9	1025603	1	Cable, power, Chile and Italy, 14' 9" (4.5 m)
9	1030859	1	Cable, power, Korea, 8' (2.4 m)
Not shown	1030135	1	Kit, packaging, SBID-7286