

SMART[®]



Service Parts Diagrams

**For Model:
SBID-7275P**

Service Parts Diagrams Revision History

Revision 1 - January, 2018

- New document

Revision 2 - June, 2018

- Add 1030837, 1030838, 1030839 and 1030840

Revision 3 - June, 2019

- Remove 1030623

Standard Warranty Terms

Base product: Three-year limited equipment warranty

First Customer Ship: January, 2018

SMART Technologies

3636 – Research Road NW
Calgary, AB T2L 1Y1
CANADA

Support +1.403.228.5940 or Toll Free 1.866.518.6791 (Canada/U.S.)

Support Fax +1.403.806.1256

www.smarttech.com/contactserviceparts www.smarttech.com



Service Parts Diagrams for the SBID-7275P

Identifying Your Product Using the Serial Number 1

Ordering Parts 1

SBID-7275P Parts 2

Identifying Your Product Using the Serial Number

To make sure that you have the correct service parts diagrams, you must verify the serial number of your SBID-7275P. The serial number of the flat panel display will be located on the right underside of the bottom bezel. The serial number of the AM40 will be located on the bottom of the appliance. An example of the serial number format is shown below.

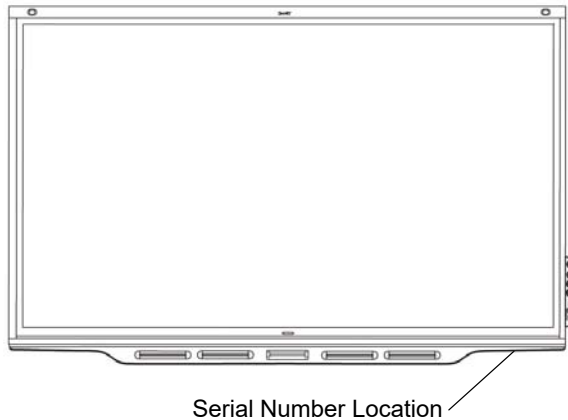

Unique Serial Number

K032JW51A0034

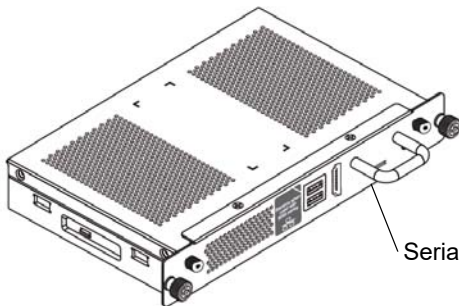

Unique Serial Number

F102JW41C00334

Ordering Parts

Customers

To order any of the parts in these service parts diagrams, contact your local reseller.
To find a reseller near you, visit www.smarttech.com/where.

Dealers and Distributors

For specific technical and pricing enquiries in regards to these diagrams please contact our service parts department.
Pricing is also available on-line via the SOURCE website (source.smarttech.com).

Web Form: www.smarttech.com/contactserviceparts
Phone: 1.888.42.SMART
International: +1.403.245.0333

SBID-7275P Parts

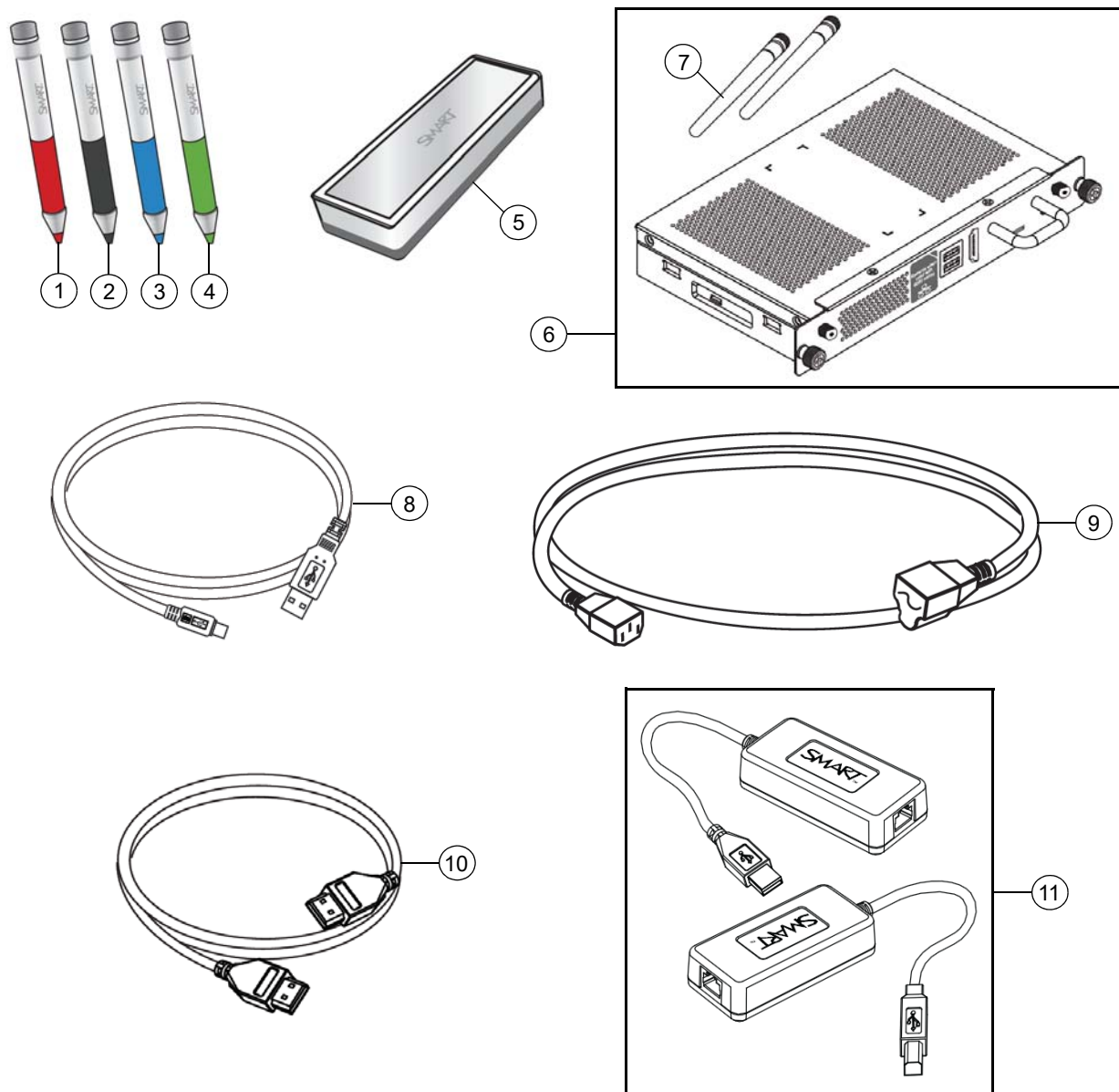

Item	Part No.	Qty	Description
1	1030840	1	Assembly, active stylus, red, single pack, professional
2	1030837	1	Assembly, active stylus, black, single pack, professional
3	1030838	1	Assembly, active stylus, blue, single pack, professional
4	1030839	1	Assembly, active stylus, green, single pack, professional
5	1030772	1	Assembly, eraser, Professional
6	UGK-AM40-ENT	1	iQ appliance for enterprise for SMART Board 6000 Pro and 7000 Pro series interactive displays NOTE: Includes AM40 and 2 pieces of item 7. NOTE: This is to replace AM40's that have a part number of 1029948.
7	1029824	2	Antenna

8	1028289	1	Cable, USB, A-B, 16' (5.0 m)
9	1022063	1	Cable, power, North America, 8' (2.4 m)
9	93-055	1	Cable, power, United Kingdom, 8' (2.4 m)
9	93-056	1	Cable, power, Australia, 8' (2.4 m)
9	93-054	1	Cable, power, Europe, 8' (2.4 m)
9	93-00708-20	1	Cable, power, China, 8' (2.4 m)
9	93-00654-20	1	Cable, power, Japan, 8' (2.4 m)
9	93-063	1	Cable, power, South Africa, 8' (2.4 m)
9	1018969	1	Cable, power, Singapore, 14' 9" (4.5 m)
9	1018970	1	Cable, power, India, 14' 9" (4.5 m)
9	1018971	1	Cable, power, Saudi Arabia, 14' 9" (4.5 m)
9	1018972	1	Cable, power, Brazil, 14' 9" (4.5 m)
9	1025597	1	Cable, power, Argentina, 14' 9" (4.5 m)
9	1025603	1	Cable, power, Chile and Italy, 14' 9" (4.5 m)
9	1030859	1	Cable, power, Korea, 8' (2.4 m)
10	1019416	1	Cable, HDMI male to HDMI male, 20' 8" (6.3 m)
11	CAT5-XT-1100	1	CAT 5 to USB Extender, CAT5 Cable not included
Not shown	1029567	1	Kit, packaging, SBID-7275P