

SMART[®]

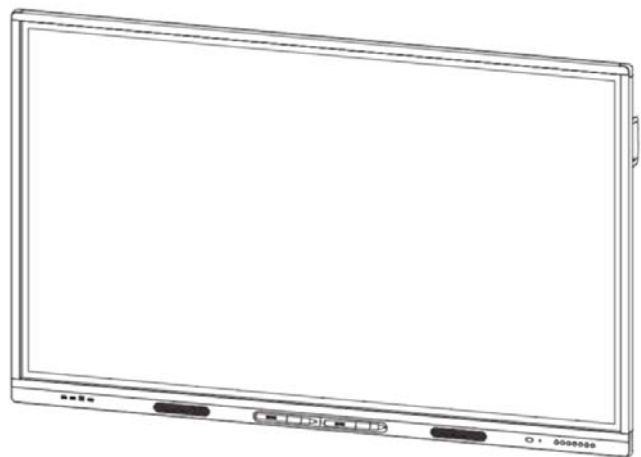

Service Parts Diagrams

For Model:

MX-V3/V3N series

MX-V3/V3N-PW series

Service Parts Diagrams Revision History

Revision 1 - December, 2021

- New document

Revision 2 - April, 2022

- Revise cover page model list

Standard Warranty Terms

Base product: Three-year limited equipment warranty

First Customer Ship: November, 2021

SMART Technologies

3636 – Research Road NW

Calgary, AB T2L 1Y1

CANADA

Support +1.403.228.5940 or Toll Free 1.866.518.6791 (Canada/U.S.)

Support Fax +1.403.806.1256

www.smarttech.com/contactserviceparts www.smarttech.com



Service Parts Diagrams for the MX-V3/V3N and MX-V3/V3N-PW series

Identifying Your Product Using the Serial Number 1

Ordering Parts 1

Service Parts 2

Optional MX Pen Replacement Nibs - Set of 10 (Part No. 1037955) 4

Identifying Your Product Using the Serial Number

To make sure that you have the correct service parts diagrams, you must verify the serial number of your display. The serial number of the flat panel display will be located on the underside of the bottom bezel.



Serial Number Location

Unique Serial Number

K052LW35F0001

Ordering Parts

Customers

To order any of the parts in these service parts diagrams, contact your local reseller.
To find a reseller near you, visit www.smarttech.com/where.

Dealers and Distributors

For specific technical and pricing enquiries in regards to these diagrams please contact our service parts department.
Pricing is also available on-line via the SOURCE website (source.smarttech.com).

Web Form: www.smarttech.com/contactserviceparts
Phone: 1.888.42.SMART
International: +1.403.245.0333

Service Parts

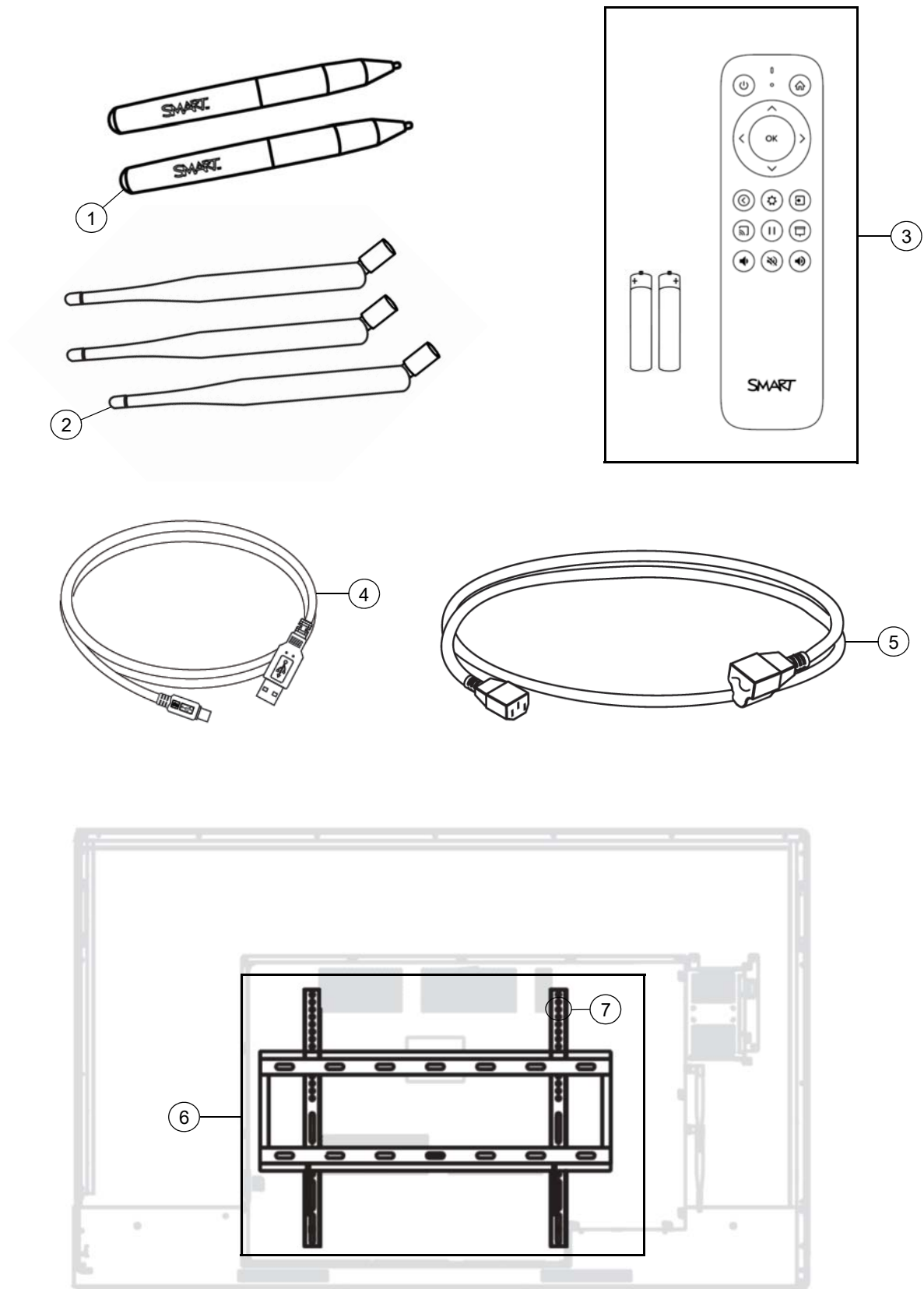

Item	Part No.	Qty	Description
1	1035668	2	Pen, SBID - MX
2	1033596	3	Antenna
3	1035792	1	Assembly, remote control
4	1028289	1	Cable, USB, A-B, 16' (5.0 m)
5	1022063	1	Cable, power, North America, 8' (2.4 m)
5	93-055	1	Cable, power, United Kingdom, 8' (2.4 m)
5	93-056	1	Cable, power, Australia, 8' (2.4 m)
5	93-054	1	Cable, power, Europe, 8' (2.4 m)
5	93-00708-20	1	Cable, power, China, 8' (2.4 m)
5	93-00654-20	1	Cable, power, Japan, 8' (2.4 m)
5	93-063	1	Cable, power, South Africa, 8' (2.4 m)
5	1018969	1	Cable, power, Singapore, 14' 9" (4.5 m)
5	1018970	1	Cable, power, India, 14' 9" (4.5 m)
5	1018971	1	Cable, power, Saudi Arabia, 14' 9" (4.5 m)
5	1018972	1	Cable, power, Brazil, 14' 9" (4.5 m)
5	1025597	1	Cable, power, Argentina, 14' 9" (4.5 m)
5	1025603	1	Cable, power, Chile and Italy, 14' 9" (4.5 m)
5	1030859	1	Cable, power, Korea, 8' (2.4 m)
6	1033778	1	Assembly, wall mount, 55" and 65" NOTE: Includes wall mount and 4 pieces of part number 1032611.
6	WM-SBID-200	1	Assembly, wall mount, 75" and 86" NOTE: Includes wall mount and 4 pieces of part number 1032611.
7	1032611	4	Screw, M8 × 24 mm, Phillips, pan head, SEMS split washer NOTE: For attaching wall mount to flat panel display.
Not shown	1034658	1	Kit, packaging, 55"
Not shown	1033617	1	Kit, packaging, 65"
Not shown	1033624	1	Kit, packaging, 75"
Not shown	1033626	1	Kit, packaging, 86"

Optional MX Pen Replacement Nibs - Set of 10 (Part No. 1037955)

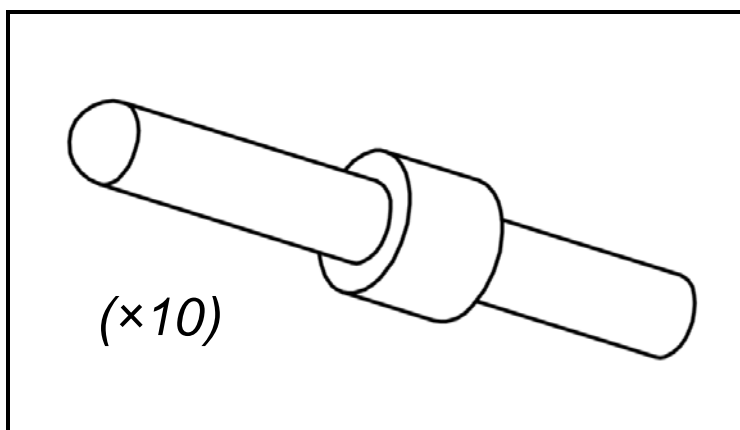

NOTE: The replacement nibs are compatible with the version of MX pen shown below.



NOTE: The replacement nibs are NOT compatible with the versions of MX pen shown below.

