

[illegible]

5 → 12

13 → 20



SBID-6000S-V3 series

1

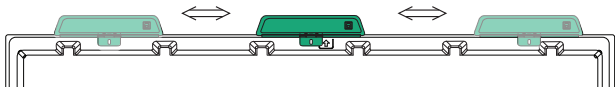

A

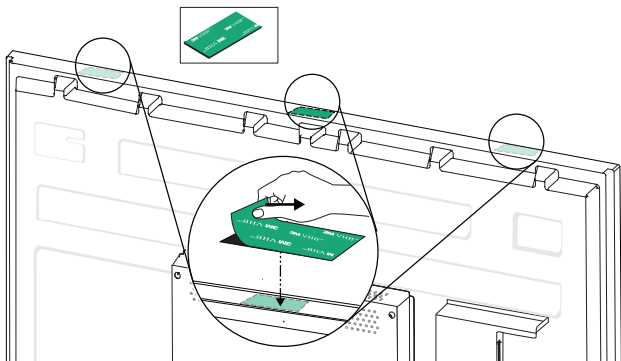

B

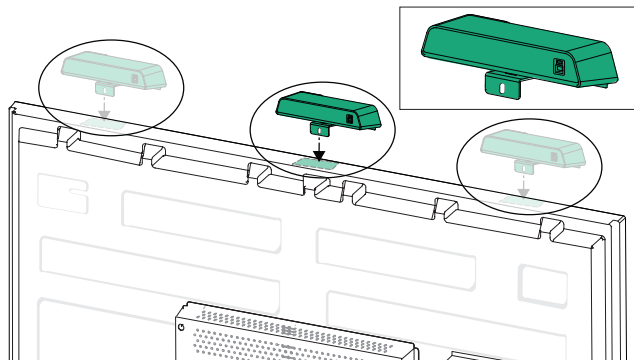

2

A

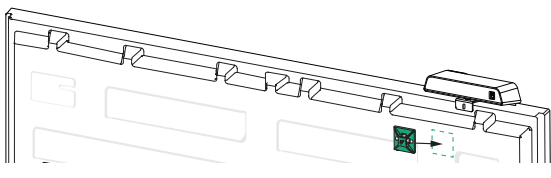
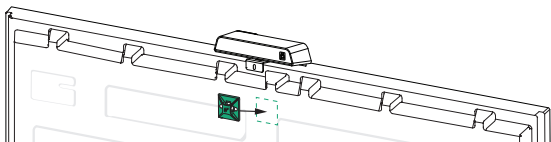

B

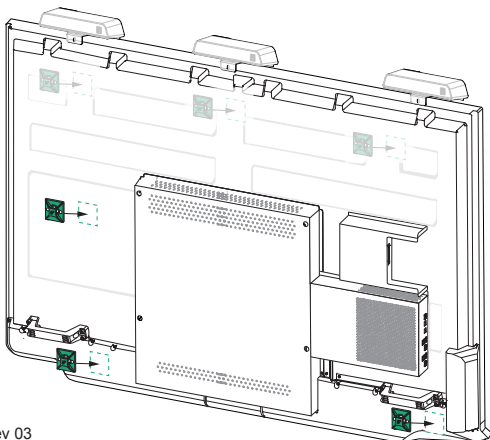

3

(×4)

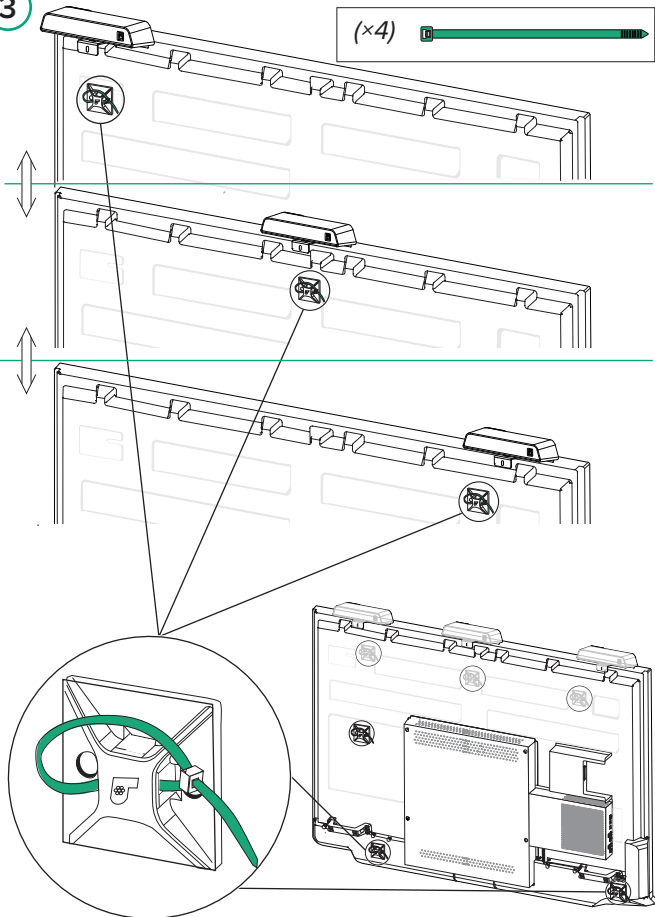

4

f

A

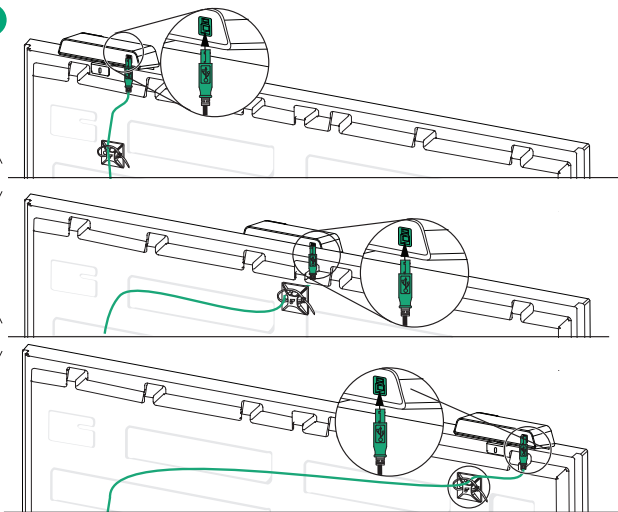

B

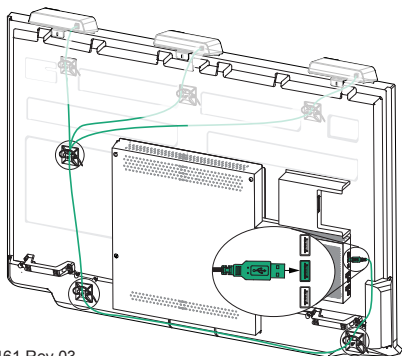

21

Pg. 17

MX-V4 series



9 → 12

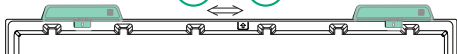

5

A

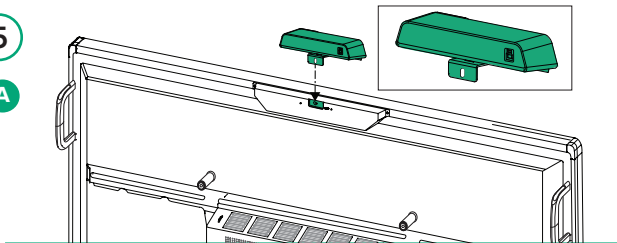

B

a (x1) c (x1)

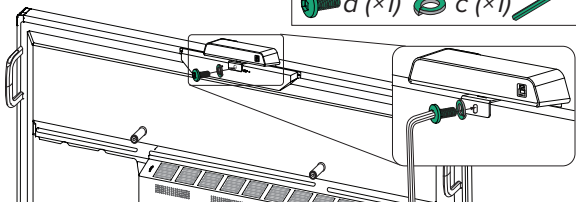

6

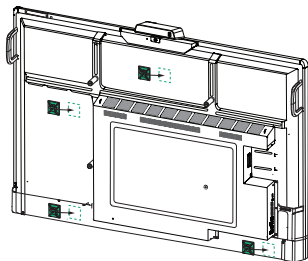
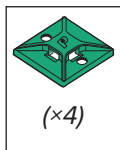

7

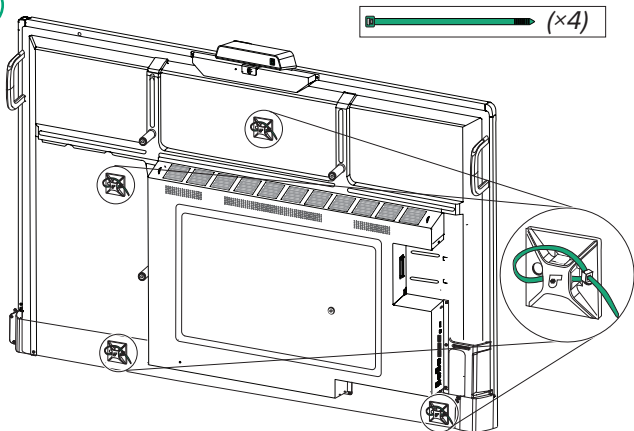

8

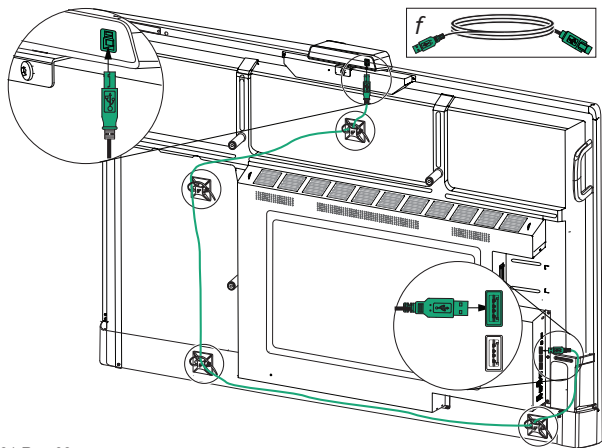

9

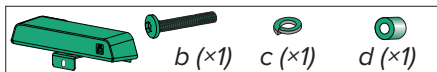

A

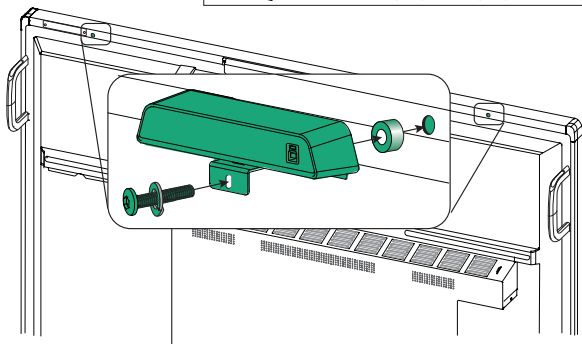

B

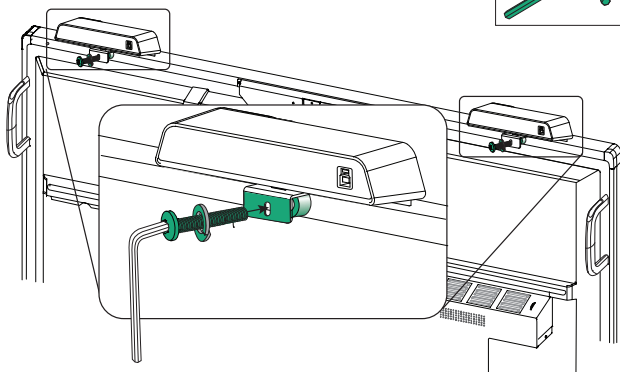
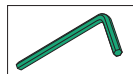

10

A

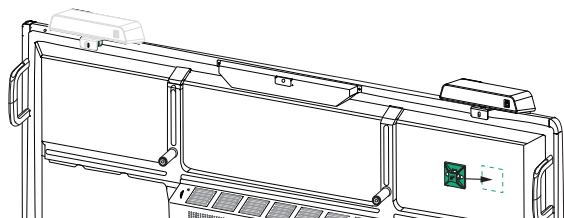
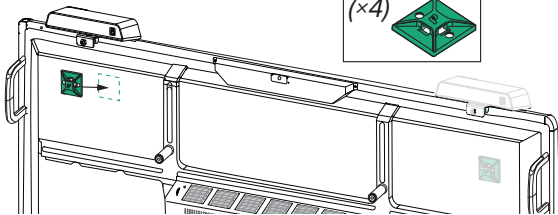

B

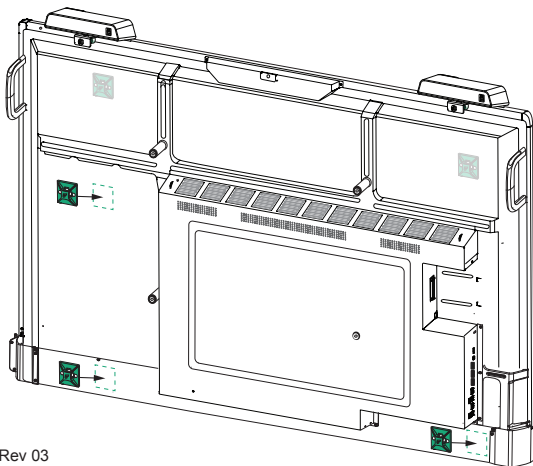

11

A

(x4) 

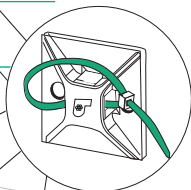
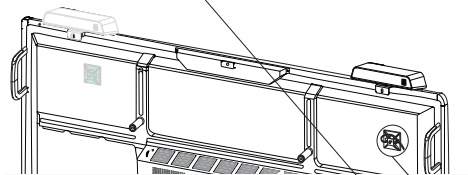
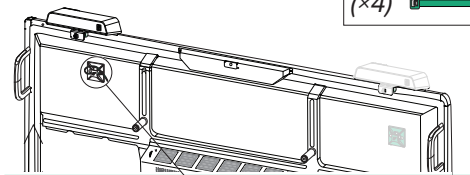

B

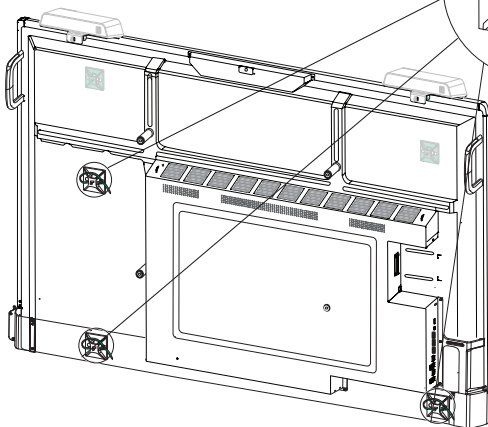

12

A

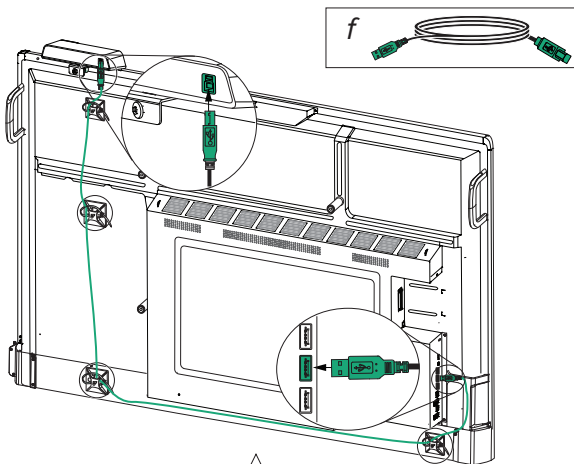

B

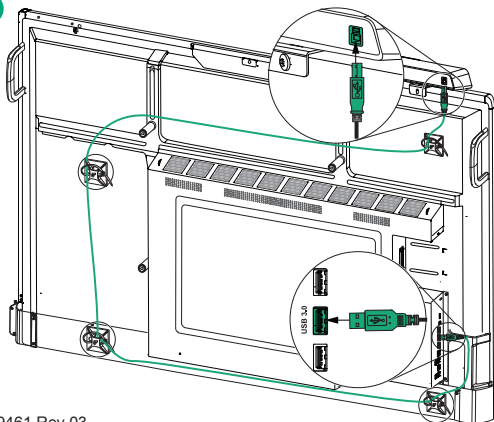

21

Pg. 17

13

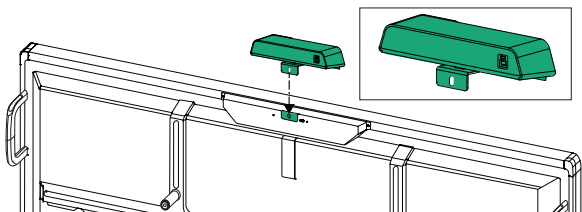

16 → 20

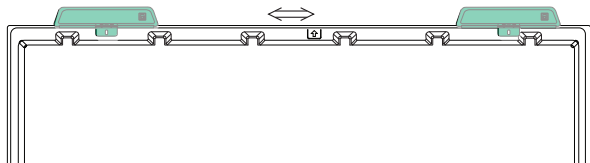

14

 a (x1)  c (x1) 

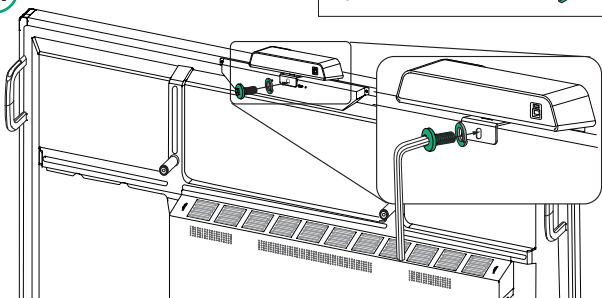

15

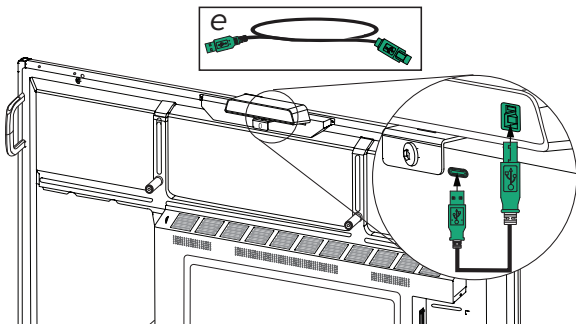

16

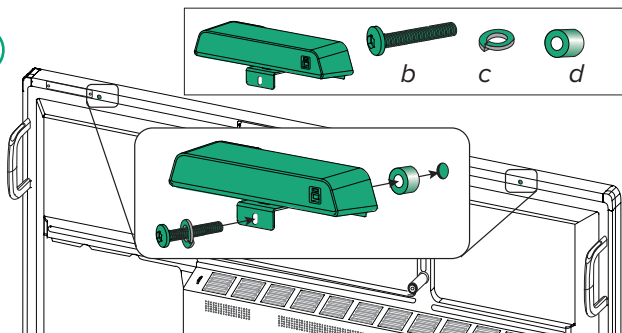

17

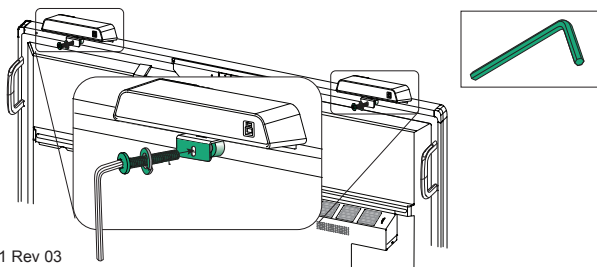

18

A

(x4)

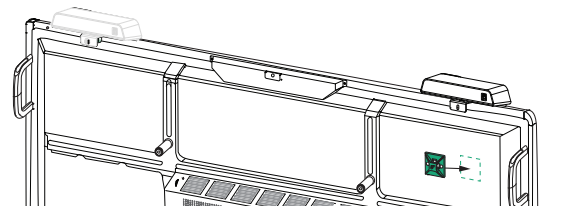
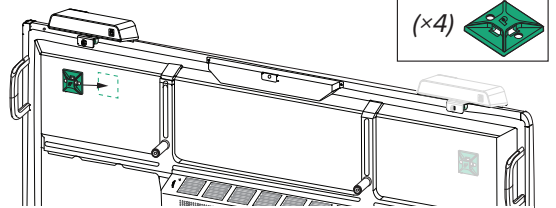

B

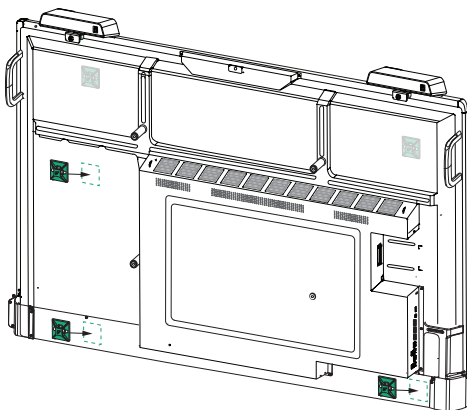

19

(x4)



A

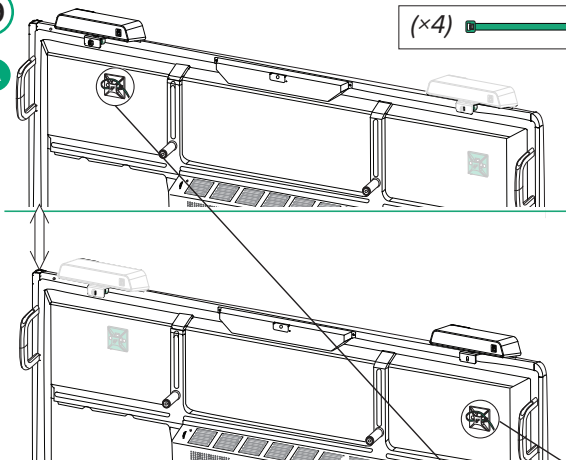

B

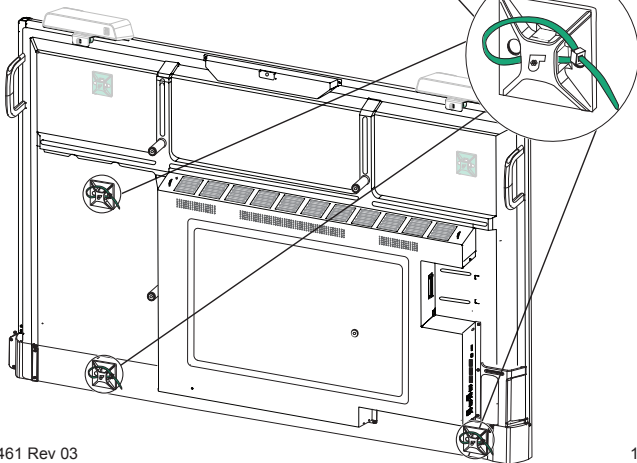

20

A

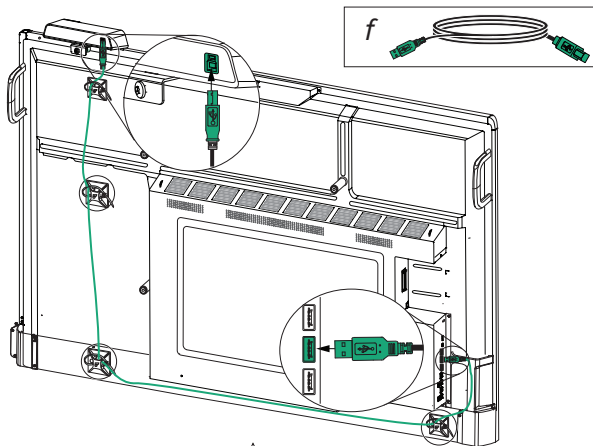

B

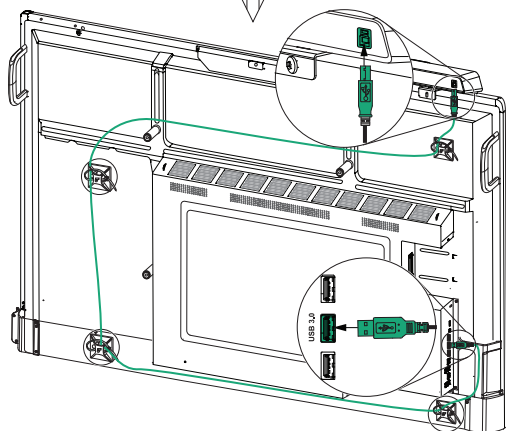

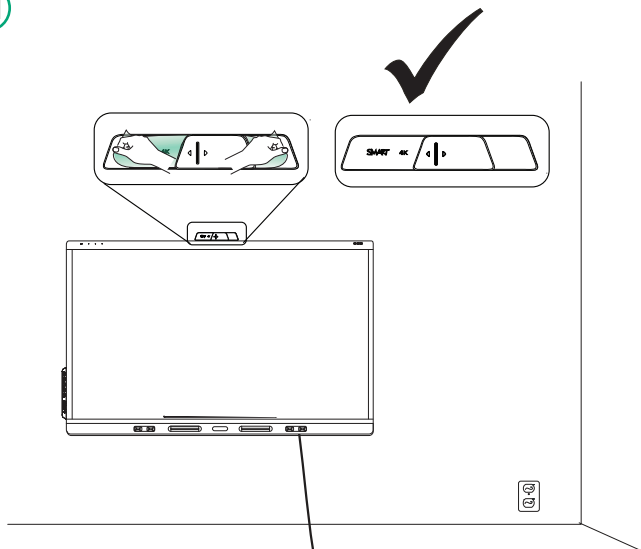

Innovation, Science and Economic Development Canada (ISED)

This device complies with CAN ICES-003(A) / NMB-003(A) of the Innovation, Science and Economic Development Canada Rules. Operation is subject to the following two conditions:

1. This device may not cause harmful interference, and
2. This device must accept any interference received, including interference that may cause undesired operation.

Cet appareil est conforme à la norme CAN ICES-003(A) / NMB-003(A) des règles d'Innovation, Science et Développement économique Canada. Son fonctionnement est soumis aux deux conditions suivantes :

1. Le dispositif ne doit pas produire de brouillage préjudiciable, et
2. Ce dispositif doit accepter tout brouillage reçu, y compris un brouillage susceptible de provoquer un fonctionnement indésirable .

Federal Communication Commission (FCC) interference statement

Supplier's Declaration of Conformity • 47 CFR § 2.1077 Compliance Information. Unique Identifier: C120-1 • Responsible Party – U.S.

Contact Information: **SMART Technologies Inc.** 2401 4th Ave, 3rd Floor, Seattle, WA 98121 • compliance@smarttech.com

This device complies with Part 15 of the FCC Rules. Operation is subject to the following two conditions:

1. This device may not cause harmful interference, and
2. This device must accept any interference received, including interference that may cause undesired operation.

NOTE: This equipment has been tested and found to comply with the limits for a Class A digital device, pursuant to Part 15 of the FCC Rules. These limits are designed to provide reasonable protection against harmful interference when the equipment is operated in a commercial environment. This equipment generates, uses, and can radiate radio frequency energy and, if not installed and used in accordance with the instruction manual, may cause harmful interference to radio communications. Operation of this equipment in a residential area is likely to cause harmful interference in which case the user will be required to correct the interference at their expense.

CAUTION! Any changes or modifications not expressly approved by the party responsible for compliance could void the user's authority to operate this equipment.

Japan VCCI Class A statement

This is a Class A product based on the standard of the Voluntary Control Council for Interference (VCCI). If this equipment is used in a domestic environment, radio interference may occur, in which case the user may be required to take corrective actions.

この装置は、クラスA情報技術装置です。この装置を家庭環境で使用すると電波妨害を引き起こすことがあります。この場合には使用者が適切な対策を講ずるよう要求されることがあります。VCCI-A

EU and UK Declaration of Conformity

Hereby, SMART Technologies ULC declares that the C120-1 complies with Directive 2014/30/EU. The full text of the EU and UK declaration of conformity is available at the following Internet address: smarttech.com/compliance.

Hardware environmental compliance

SMART Technologies supports global efforts to ensure that electronic equipment is manufactured, sold and disposed of in a safe and environmentally friendly manner.

Waste Electrical and Electronic Equipment and Battery regulations (WEEE and Battery Directives)



Electrical and electronic equipment contain substances that can be harmful to the environment and to human health. The crossed-out wheeled bin symbol indicates that products should be disposed of in the appropriate recycling stream and not as regular waste.

See smarttech.com/compliance for more information.



Batteries

The remote contains two AAA batteries. Recycle or dispose of batteries properly.

危险材料表 (Hazardous Materials Table) 按照SJ/T 11364的规定，请访问

查阅本产品有害物质表 smarttech.com/compliance

In accordance with the provisions of SJ/T 11364, please visit smarttech.com/compliance for this product's hazardous materials table.



support.smarttech.com/support

support.smarttech.com/contact-support

SMART Board® SMART

© 2023 SMART Technologies ULC. All rights reserved. SMART Board, smarttech, the SMART logo and all SMART taglines are trademarks or registered trademarks of SMART Technologies ULC in the U.S. and/or other countries. All third-party products and company names may be trademarks of their respective owners. Contents are subject to change without notice. This product and/or use thereof covered by one or more of the following U.S. patents; smarttech.com/patents. Other patents pending. Apr 2023

smarttech.com/kb/171858

